

Congratulations, you have purchased the finest exhaust system available for your motorcycle. Your Vance & Hines exhaust is designed and crafted for performance, quality, and style. Please follow the instructions below, check exhaust system for missing or damaged parts and if you need any assistance please contact our technical support line (562) 921-7461.

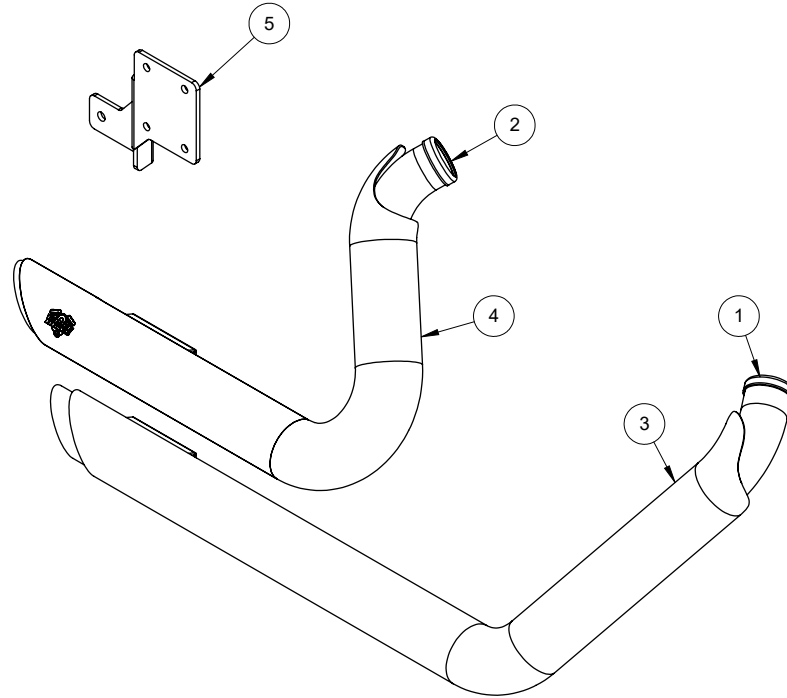

PARTS LIST

NO.	PART NO.	Description	Qty.
1	D442FC	Front Head Pipe	1
2	D443FC	Rear Head Pipe	1
3	D475HC/D477HP	Front Heat Shield	1
4	D476HC/D478HP-S	Rear Heat Shield	1
5	424-P	Mounting Bracket	1
6	A270HW	1.75" Hose Clamp	5
7	A272HW	2.25" Hose Clamp	2
8	A195HW	Dogbone Nutplate	3
9	A240HW	5/16"-18X5/8" Flange Head Bolt	4
10	A290HW	3/8"-16X3/4" Flange Head Bolt	2
11	A101HW	3/8"-16X2.5" Socket Head Screw	1
12	A167HW	Exhaust Gasket	2

HARDWARE

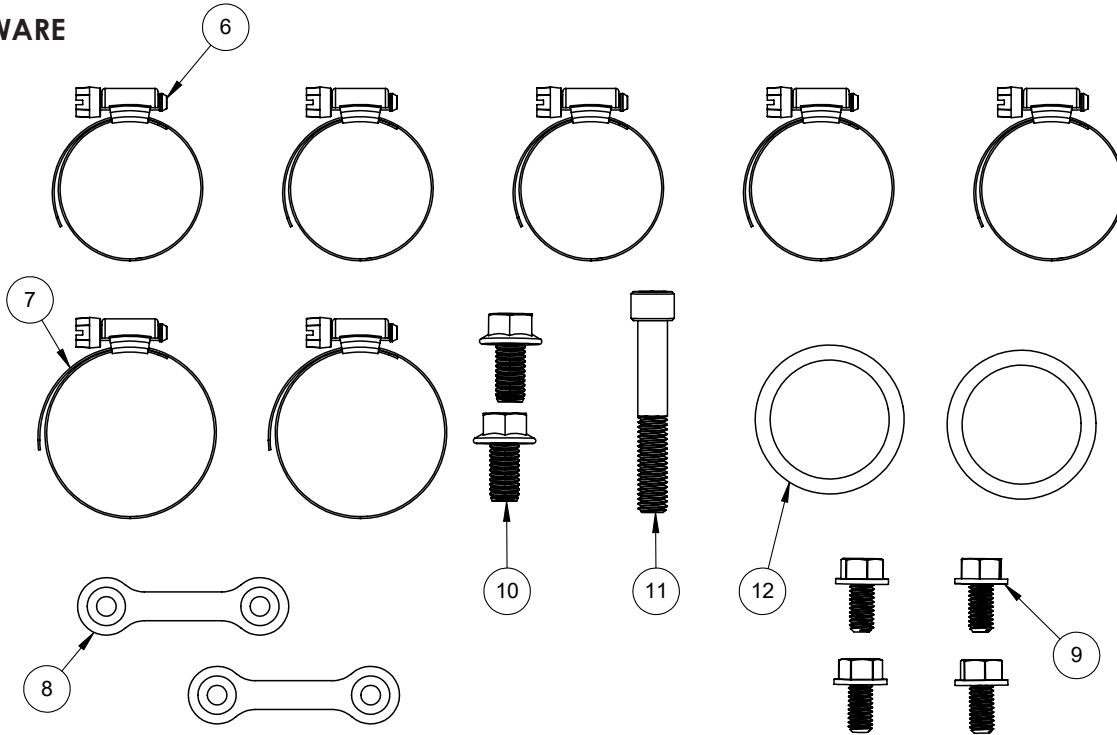

TOOLS REQUIRED

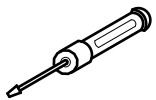

Flat Head Screwdriver
and #3 Phillips Head

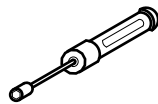

5/16 Nut Driver

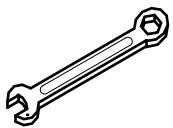

Combination Wrench:
1/2", 3/4", 7/8", 14mm,
22mm

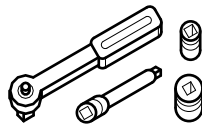

3/8" Drive Ratchet & extension
1/2" Socket
7/16" Deep Socket
9/16" Deep Socket

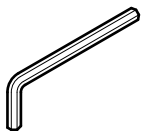

Allen Wrenches: 3/16",
1/4"

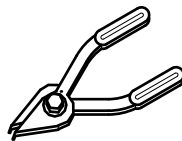

Snap Ring Pliers

STOCK EXHAUST SYSTEM REMOVAL

1. Remove seat to gain access to rear oxygen sensor connector. Unplug sensor and feed end of wire through frame so that it is free from motorcycle. NOTE: Pay attention to wire routing for re-installation.
2. Unplug the front sensor (located behind the rectifier) from harness and feed the end of the wire through the frame, freeing it from motorcycle.
3. On FLSTC, FLSTF, and FLSTN (floorboard models), loosen the right hand floorboard mounting bolts to gain clearance for exhaust removal and installation.
4. If equipped, unbolt the carriage bolt and clamp attached to the bracket under the right side transmission cover.
5. On FLSTF, FXS and FLSTN (foot peg models), you will need to remove the right side passenger footpeg and hanger, as this is attached to the exhaust mount bracket. Replace the passenger foot peg assembly using the 3/8" x 2 1/2" Allen bolt (supplied).
6. Loosen the heat shield clamps on both front and rear exhaust pipes.
7. Remove the two mounting nuts from each head pipe, located at the cylinder head.
8. Remove the nuts attaching the exhaust mount bracket to the frame.
9. Remove the entire exhaust system and set it aside.
10. Remove the two lower mounting studs from the frame using the 3/4" deep socket (Figure 1).
11. If equipped, remove the bracket from under the right side transmission cover.
12. Using 14mm wrench, carefully remove the O2 sensors from the stock header and save them for re-use with the new system.
13. Carefully remove exhaust port flanges and circlips from the stock exhaust system using snapping pliers. NOTE: Replace bent or damaged circlips.
14. Remove stock exhaust gaskets and replace them with the supplied exhaust gaskets
NOTE: Replacement gaskets HD Screaming eagle #17048-98 or equivalent.

VANCE & HINES EXHAUST INSTALLATION

1. Remove head pipes and heat shields from protective packaging. Place each heat shield on a non-abrasive surface such as a blanket or carpet. Using a felt tip pen, mark outside edge of each heat shield to show location of hose clamp mounting clips (Figure 3).
2. Lay head pipes into head pipe heat shields (Figure 2) and loosely install the #20 hose clamps (supplied) into mounting clips (Figure 3). NOTE: Muffler heat shields will be tightened after pipes are on the motorcycle. Screw heads should be accessible when system is installed on motorcycle for adjustment purposes (Figure 4). Do not tighten at this time.
3. Apply a small amount of anti-seize compound to the threads of the O2 sensors removed from the stock head pipes and install them into the new head pipes. NOTE: Install O2 sensor with gray connector (short) in the front head pipe and the O2 sensor with black connector (long) into rear head pipe. Be careful not to get anti-seize on sensor tip, it may affect sensor function.
4. Install exhaust port flanges and circlips (from stock system) onto head pipes (Figure 4).
5. Attach mounting bracket 424-P using four 5/16"x5/8" flange bolts and two nut plates (supplied). Slide nut plates inside brackets that are welded to backside of each muffler (Figure 5). Leave them loose at this time. Use this procedure for mounting both upper and lower mufflers.
6. Install complete assembly into exhaust ports (rear port first). Use stock flange nuts, do not tighten at this time. Install two 3/8"x3/4" flange bolts (supplied) attaching exhaust bracket to the right side lower frame rail of motorcycle.
7. Tighten exhaust port flange nuts, bracket bolts and bolts mounting pipes to bracket while making sure pipes are parallel.
8. Tighten all hose clamps NOTE: Muffler bodies should protrude from heatshields by 1/4" (Figure 6).
9. Feed connector for the rear O2 sensor (Black) through the frame and under the seat. Re-install battery, plug the sensor into the stock wiring connector.
10. Feed connector for the front O2 (Gray) sensor through the frame and into the holder on the frame behind rectifier. Plug the sensor into the stock wiring connector.
11. Tighten the floor board mounting bolts on models so equipped.
12. Check for adequate clearance of all exhaust system components and motorcycle accessories prone to heat damage.
13. After installation and before starting the motorcycle, check all hardware for tightness and completely clean pipes and mufflers with warm soapy water and a clean soft cloth that will not leave a residue. NOTE: Any residue, oil, or fingerprints will stain the chrome when the metal heats up.

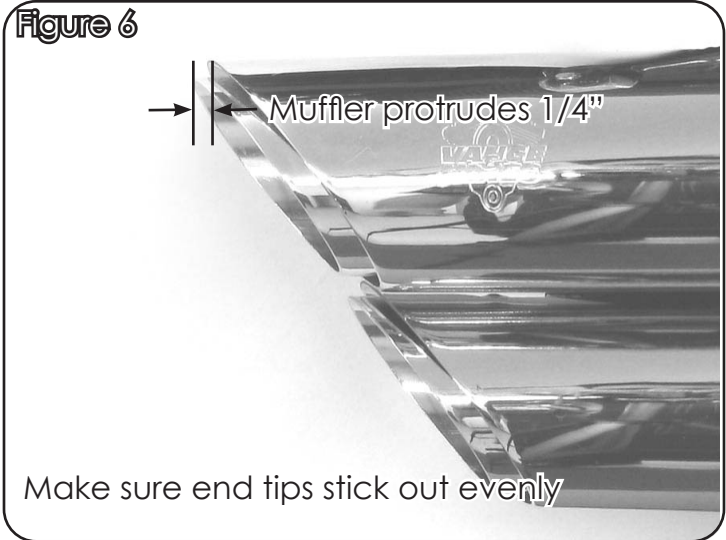
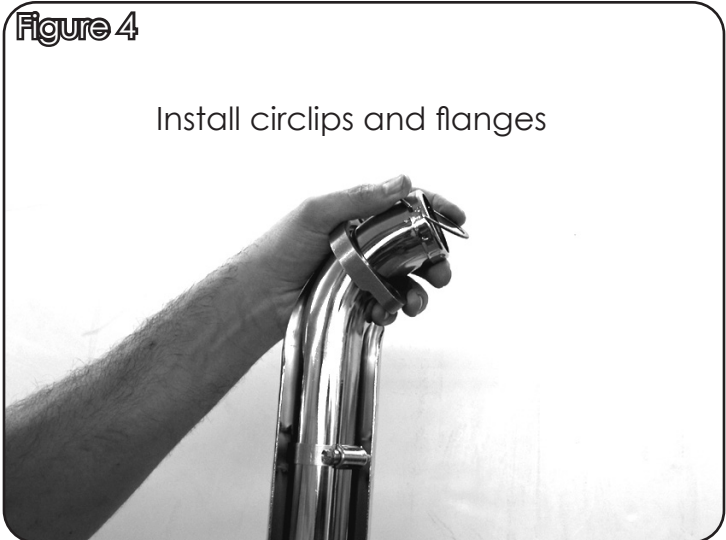
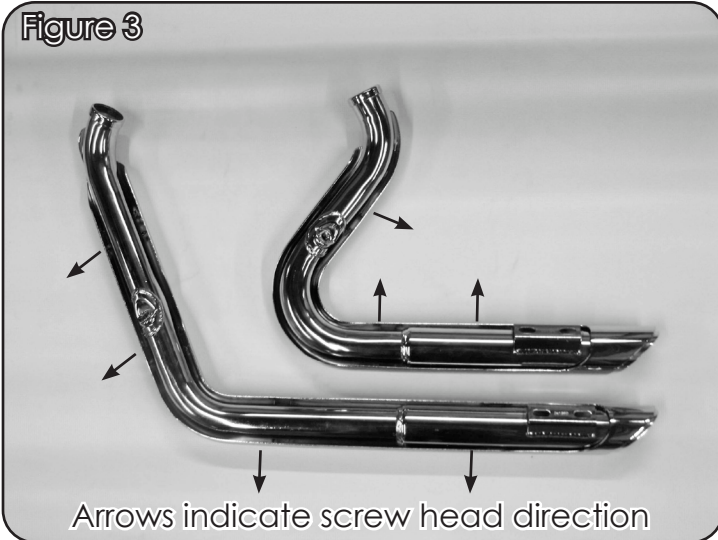
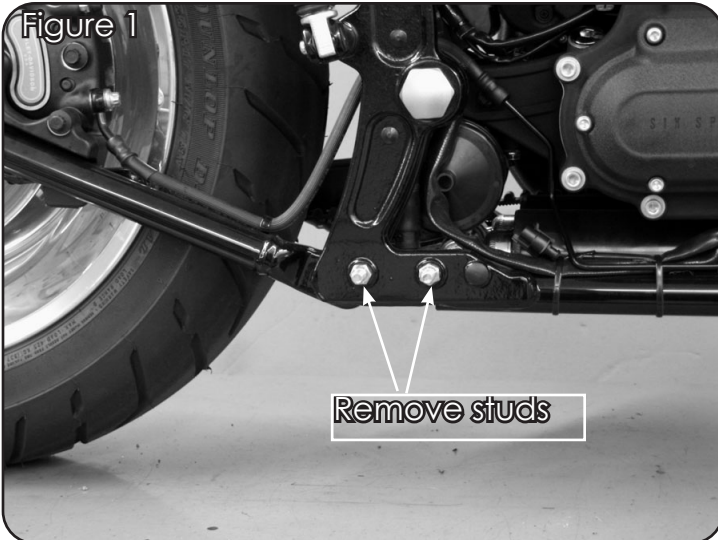

Emissions Notice:

In California, in order to meet Air Resources Board emissions requirements, certain aftermarket part applications have been identified as replacements, and others have received ARB Executive Orders. All other emissions related aftermarket parts are for competition use only. A list of replacement parts and EO parts, and corresponding fitment is provided at vanceandhines.com/California.

Warranty:

All Vance & Hines products are warranted against defects in material and workmanship for a period of 90 days. This warranty does not cover discoloration or rust. This warranty shall be limited to the repair or replacement of the product, which may be proven defective under normal use. Vance & Hines will not warranty any system that has been abused, misused, improperly installed or modified.

Dealers or distributors are not authorized to make dispositions binding upon Vance & Hines. Vance & Hines will not be responsible for any labor charges incurred in removing or replacing any system under warranty. A return authorization number and a copy of the original purchase invoice must accompany all returns. Parts returned without a return authorization may be refused.

13861 ROSECRANS AVENUE / SANTA FE SPRINGS, CA 90670
SALES: (562) 921-5388
TECHNICAL: (562) 926-5291
FAX: (562) 802-0110

vanceandhines
.com