

POWER COMMANDER 6

Install guide for: PC6-17050

Model coverage: 2004-2006 Kawasaki Z750/Z750S

POWER COMMANDER 6

PARTS LIST



- | | | | |
|---|--------------------|---|------------------------|
| 1 | POWER COMMANDER 6 | 2 | POWER COMMANDER DECALS |
| 1 | INSTALLATION GUIDE | 2 | VELCRO STRIPS |
| 1 | USB CABLE | 1 | ALCOHOL SWAB |
| 2 | DYNOJET DECALS | 1 | POSI-TAP |

**PLEASE READ ALL DIRECTIONS BEFORE STARTING INSTALLATION.
THE IGNITION MUST BE TURNED OFF BEFORE INSTALLATION.**



IPC6-17050.01

INPUT ACCESSORY GUIDE

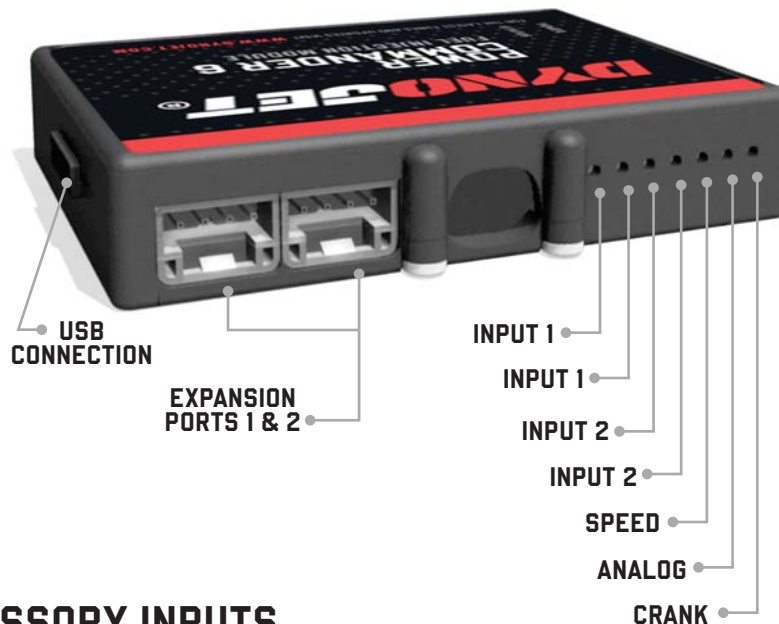

OPTIONAL ACCESSORY INPUTS

- Map** (Input 1 or 2) The PC6 has the ability to hold 2 different base maps. You can switch on the fly between these two base maps when you hook up a switch to the MAP inputs. You can use any open/close type switch. The polarity of the wires is not important.
- Shifter** (Input 1 or 2) Used for clutch-less full throttle upshifts. Insert the wires from the Dynojet quick shifter into either Input 1 or Input 2. The polarity of the wires is not important. Set to Input 2 by default.
- Speed** If your application has a speed sensor then you can tap into the signal side of the sensor and run a wire into this input. This will allow you to calculate gear position in the Control Center Software. Once gear position is setup you can alter your map based on gear position and setup gear dependent kill times when using a quick shifter.
- Analog** This input is for a 0-5v signal such as engine temp, boost, etc. Once this input is established you can alter your fuel curve based on this input in the Power Core software.
- Launch** You can connect a wire to either Input 1 or Input 2 and then the other end to a switch. This switch when engaged (continuity) will only allow the RPM to be raised to a certain limit (set in the software). When released, you will have full RPM.

WIRE CONNECTIONS

To input wires into the PC6 first remove the rubber plug on the backside of the unit and loosen the screw for the corresponding input. Using a 22-24 gauge wire, strip about 10mm from its end. Push the wire into the hole of the PC6 until it stops and then tighten the screw. Make sure to reinstall the rubber plug.

NOTE: If you tin the wires with solder it will make inserting them easier.



INSTALLING THE POWER COMMANDER 6

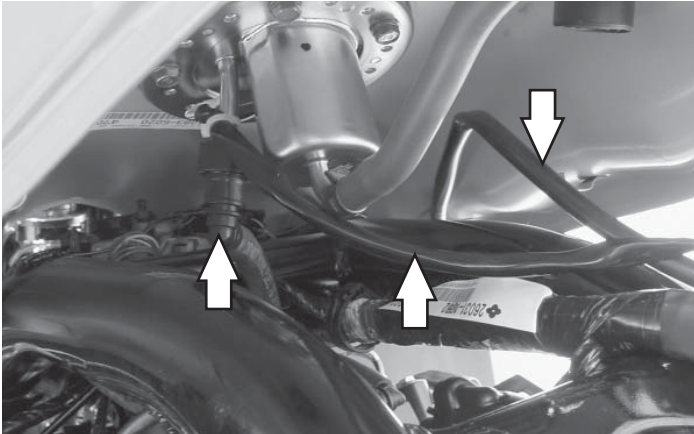

- 1 Remove the main seat and the passenger seat.
- 2 Remove the fuel tank.

This installation can be done without removing the fuel tank, but it may be easier to remove the fuel tank.
- 3 Remove the fuel line by squeezing the sides of the connector.
- 4 Disconnect the two electrical connectors.

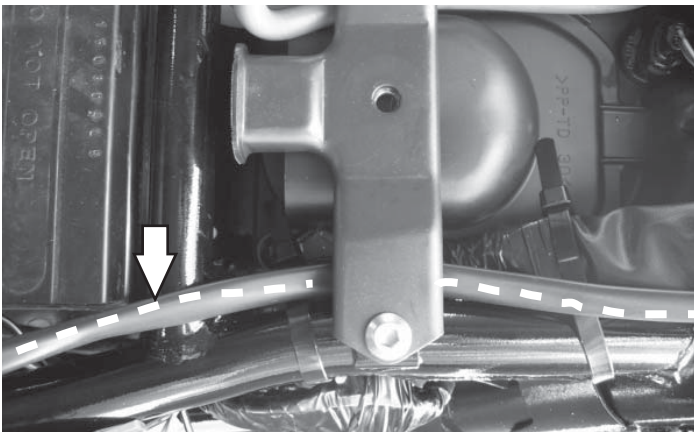

- 5 Lay the PC6 in the tail section.
- 6 Route the PC6 harness towards the throttle bodies. Keep the harness between the frame and the tail section.
- 7 Route the PC6 harness underneath the fuel tank bracket.

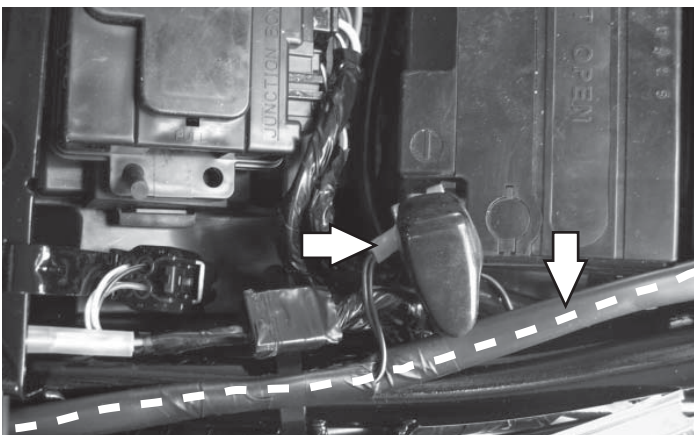

- 8 Attach the ground wire from the PC6 harness to the negative side of the battery.

9 Unplug the stock wiring harness from the injectors.

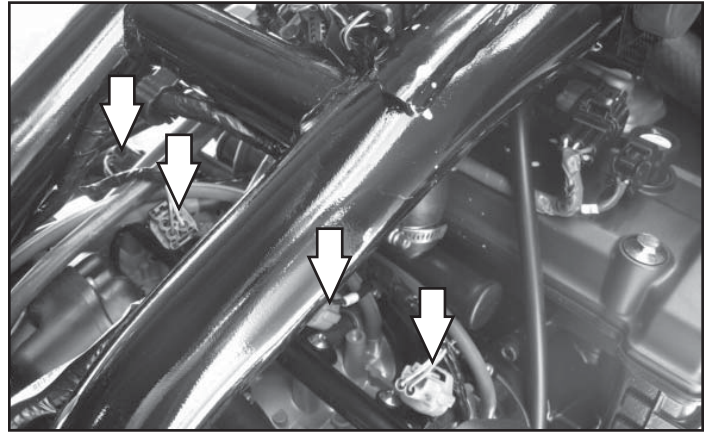

10 Attach the connectors from the PC6 to the stock wiring harness and injectors.

Connect the orange colored wires to cylinder #1 (left) and work towards the right.

This image shows cylinder #4 being connected.

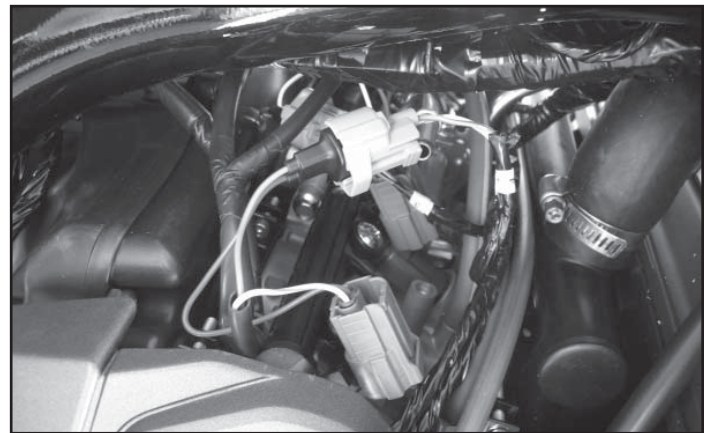

11 Locate the primary throttle position sensor on the right hand side of the throttle bodies.

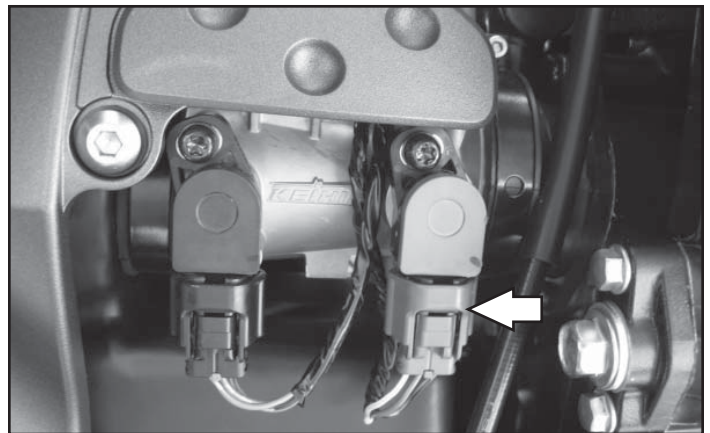

12 Attach the supplied Posi-tap to the stock YELLOW/WHITE wire.

13 Attach the GREY wire from the PC6 to the Posi-tap.

Dynojet recommends using dielectric grease on these connections.

The wire tap used in this image is not a Posi-tap. This is an older crimp-on style wire tap.

Note: This connection will be visible, so you may wish to connect the wire tap further up the wiring harness.

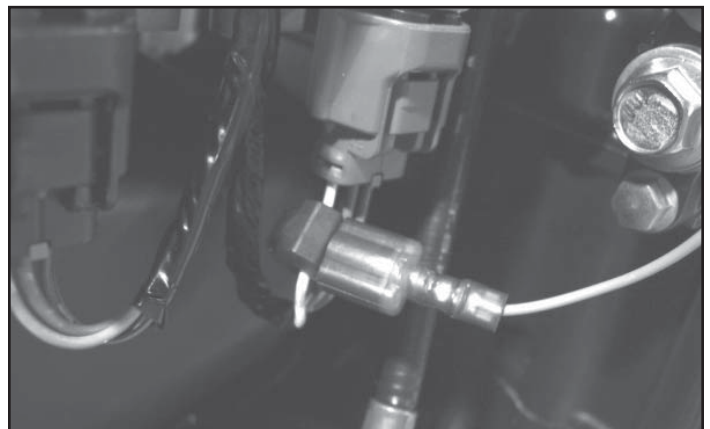
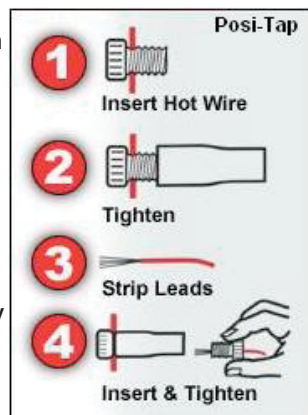



- 14 Using the supplied Velcro, secure the PC6 inside the tail section.

Clean both surfaces with the supplied alcohol swab prior to applying the Velcro adhesive.

- 15 Reinstall the fuel tank and seat.

Download the latest map files from our web site at dynojet.com/tunes.



PUSH THE LIMIT

2191 MENDENHALL DRIVE, NORTH LAS VEGAS, NV 89081 - 800-992-4993 - DYNOJET.COM

© 2004-2022 DYNOJET RESEARCH ALL RIGHTS RESERVED