

POWER COMMANDER 6

Installation Guide for: PC6-14013

Model Coverage: 2007-2009 Ducati Multistrada 1100

DUKATI

PARTS LIST

×

- | | | | |
|---|------------------------|---|---------------|
| 1 | POWER COMMANDER 6 | 2 | VELCRO STRIPS |
| 1 | INSTALLATION GUIDE | 1 | ALCOHOL SWAB |
| 1 | USB CABLE | 1 | ZIP TIE |
| 2 | DYNOJET DECALS | 1 | POSI-TAP |
| 2 | POWER COMMANDER DECALS | | |

**PLEASE READ ALL DIRECTIONS BEFORE STARTING INSTALLATION.
THE IGNITION MUST BE TURNED OFF BEFORE INSTALLATION.**

×

IPC6-14013.01

INPUT ACCESSORY GUIDE

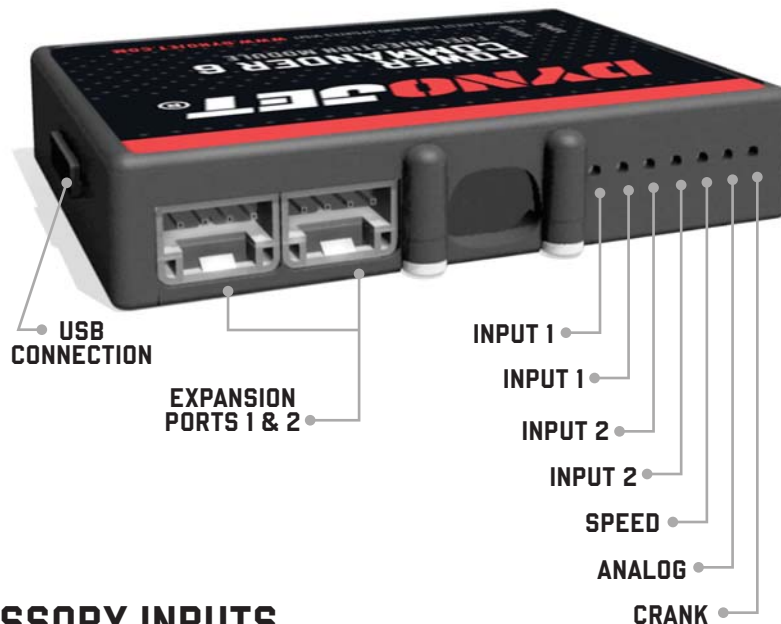

OPTIONAL ACCESSORY INPUTS

- Map** (Input 1 or 2) The PC6 has the ability to hold 2 different base maps. You can switch on the fly between these two base maps when you hook up a switch to the MAP inputs. You can use any open/close type switch. The polarity of the wires is not important.
- Shifter** (Input 1 or 2) Used for clutch-less full throttle upshifts. Insert the wires from the Dynojet quick shifter into either Input 1 or Input 2. The polarity of the wires is not important. Set to Input 2 by default.
- Speed** If your application has a speed sensor then you can tap into the signal side of the sensor and run a wire into this input. This will allow you to calculate gear position in the Control Center Software. Once gear position is setup you can alter your map based on gear position and setup gear dependent kill times when using a quick shifter.
- Analog** This input is for a 0-5v signal such as engine temp, boost, etc. Once this input is established you can alter your fuel curve based on this input in the Power Core software.
- Launch** You can connect a wire to either Input 1 or Input 2 and then the other end to a switch. This switch when engaged (continuity) will only allow the RPM to be raised to a certain limit (set in the software). When released, you will have full RPM.

WIRE CONNECTIONS

To input wires into the PC6 first remove the rubber plug on the backside of the unit and loosen the screw for the corresponding input. Using a 22-24 gauge wire, strip about 10mm from its end. Push the wire into the hole of the PC6 until it stops and then tighten the screw. Make sure to reinstall the rubber plug.

NOTE: If you tin the wires with solder it will make inserting them easier.

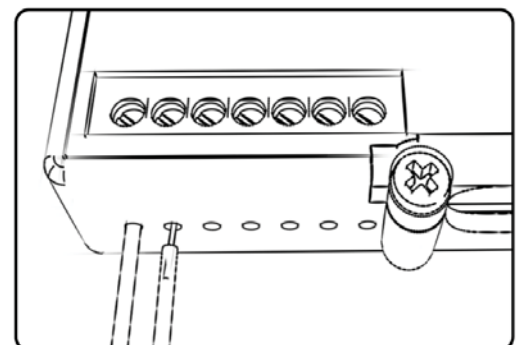

INSTALLING THE POWER COMMANDER 6



- 1 Remove the left and right side panels.
- 2 Using the supplied Velcro, secure the PC6 module to the battery.

Make sure to use the supplied alcohol swab to clean both surfaces before attaching the Velcro.
- 3 Secure the PC6 ground wire with the small ring lug to the negative (-) battery terminal.



- 4 Locate the Throttle Position Sensor (TPS) on the left side of the throttle body.
- 5 Unplug the stock connector from the bike's TPS to gain access to the wiring harness.



- 6 Using the supplied Posi-tap, attach the single unterminated GREY wire of the PC6 to the stock ORANGE wire of the bike's TPS wiring harness.

This is pin position C on the stock TPS connector.

The wire tap shown is not a Posi-tap. This is an older crimp-on style wire tap.

- 7 After attaching the GREY wire, plug the stock TPS connector back onto the TPS.

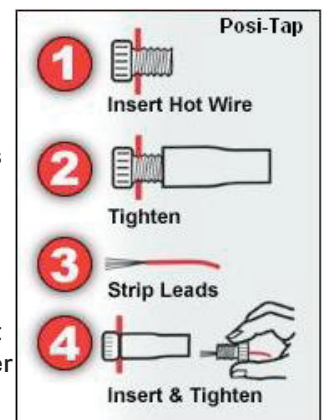

- 8 Route the PC6 wiring harness up to throttle bodies.

It is possible to install the PC6 without removing the fuel tank and the air box, although removing them may aid in the install.

- 9 Unplug the stock wiring harness from the rear fuel injector.

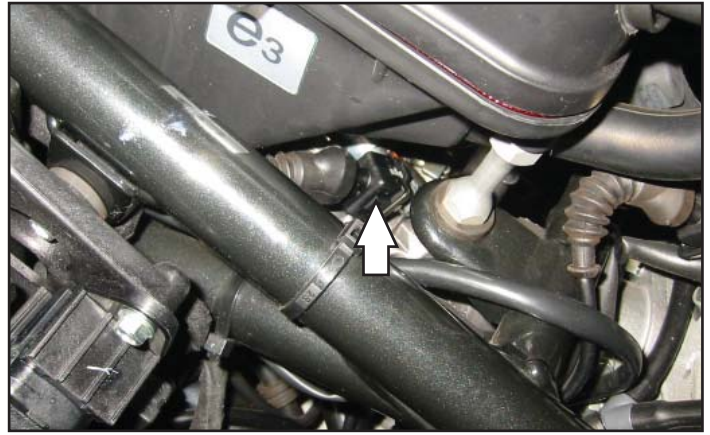

- 10 Plug the pair of PC6 leads with YELLOW colored wires in-line of the stock wiring harness and the rear fuel injector.

- 11 Route the PC6 harness under the throttle bodies to the right side of the bike.

- 12 Repeat steps 9 & 10 for the front fuel injector using the pair of PC6 leads with the ORANGE colored wires.

- 13 Reinstall the left and right side panels.



Download the latest map files from our web site at dynojet.com/tunes.



PUSH THE LIMIT

2191 MENDENHALL DRIVE, NORTH LAS VEGAS, NV 89081 - 800-992-4993 - DYNOJET.COM

© 2007-2022 DYNOJET RESEARCH ALL RIGHTS RESERVED