

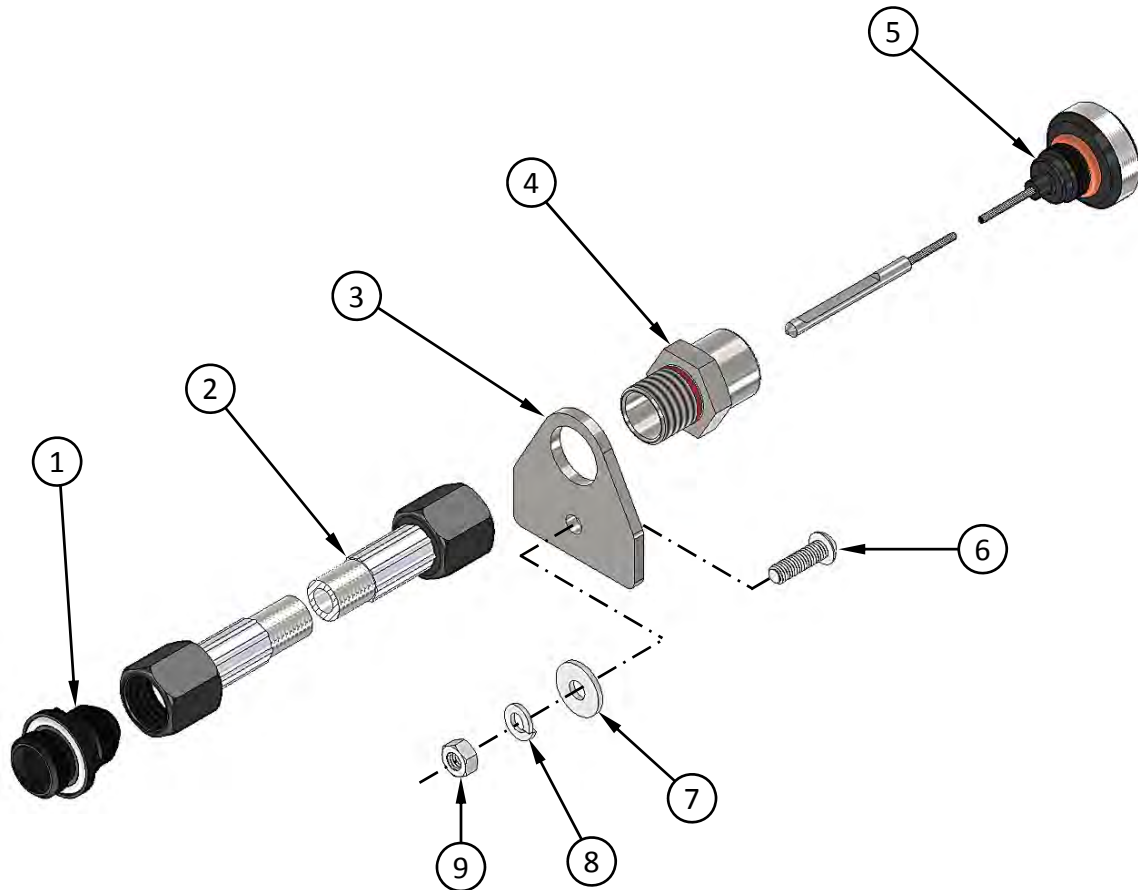

**Installation Instructions for  
22303  
REMOTE TRANSMISSION DIPSTICK  
2016-20 YAMAHA YXZ1000R**



ITEM NO.	PART NO.	DESCRIPTION	QTY.
1	1601017	FITTING (W/O-RING), DIPSTICK TUBE, YAM. YXZ1000R	1
2	1601015	HOSE ASSY, 32" STAINLESS STEEL / TEFLON	1
3	1601016	BRACKET, DIPSTICK, YAMAHA YXZ1000R	1
4	1600977	ADAPTER (W/O-RING), DIPSTICK TUBE, YAM. YXZ1000R	1
5	1601014	DIPSTICK ASSY (W/O-RING), YAMAHA YXZ1000R	1
6	3401579	SCREW, M6-1.0 x 20MM, BUTTON HEAD, CAP	1
7	3401374	WASHER, M6 OVERSIZED FLAT	1
8	3401580	WASHER, M6 SPLIT LOCK	1
9	3401566	NUT, HEX M6-1.0	1
[NOT SHOWN]	5000254	CABLE TIE, 6.75" L x 0.178" W x 0.056" T	2

Before starting, take a moment to read and understand these instructions. Use the parts drawing and list to verify your kit's contents. In the unlikely event of missing parts, please contact B&M Technical Support for replacements. We highly recommend that you retain all factory parts.

When removing fasteners, keep track of their locations to avoid fastener mix-ups at reassembly.

**We highly recommend that you retain all factory parts replaced by this kit.**

### REMOVE THE STOCK DIPSTICK:

1. **Securely chock the vehicle's wheels to keep it from rolling if the shifter or parking brake levers are manipulated.**



2. Remove the passenger seat cushion from the vehicle by lifting up sharply at the front of the cushion.



3. Remove the seat back by removing the four bolts.

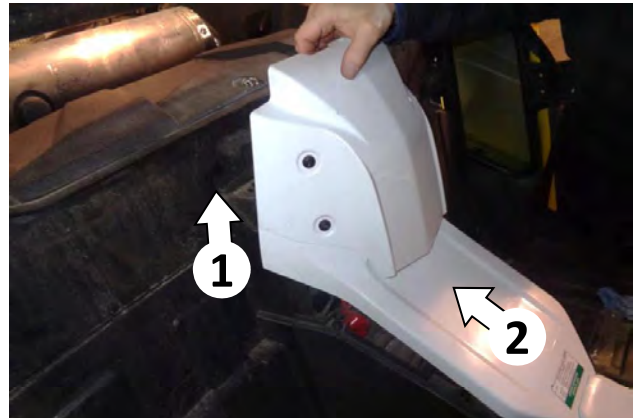

4. Remove the rear console cover. First grasp its rear end and firmly lift up to unsnap its two pins from their grommets. Then pull the cover slightly rearward to disengage the locating tab at the front.

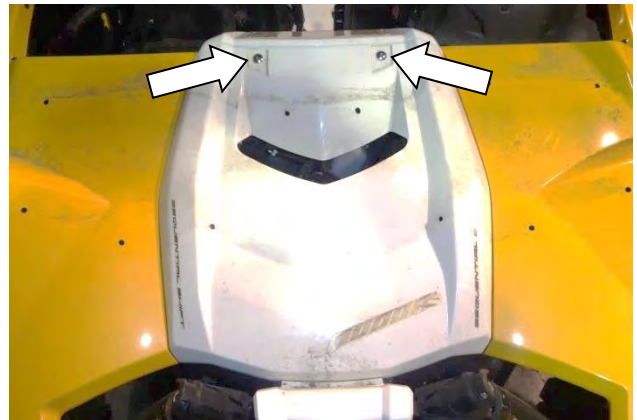

5. Remove the two screws at the rear of the service cover.

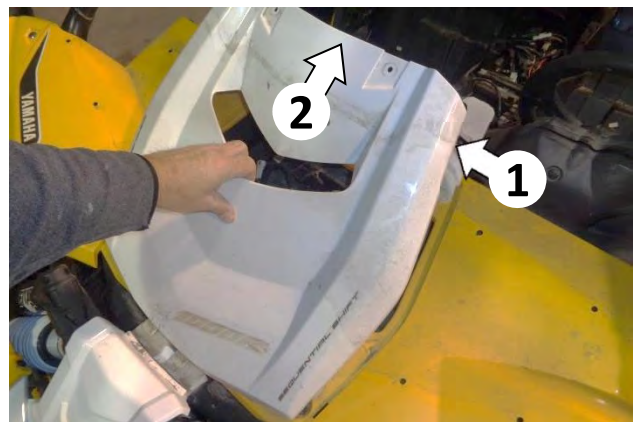

6. Remove the service cover by lifting up its rear end, then pulling the cover slightly rearward to disengage the locating tabs at the front.



7. Remove the two screws at the front of the front console cover.



8. Use a plastic trim removal tool and a screwdriver to remove the plastic push rivet at the rear of the front console cover. Then remove the cover.

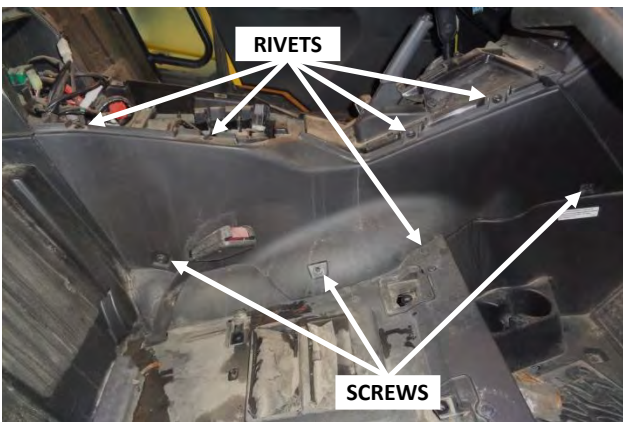

9. On the console side cover, remove the five plastic push rivets (four along the top and one at the bottom), and the three screws along the bottom.



10. Carefully remove the console side cover.



11. Clean the filler cap and surrounding area to prevent loose dirt from falling into the fill port. Then remove the cap, wipe the dipstick with a clean rag, and insert it back into the case without screwing it in (let it just rest on the opening).

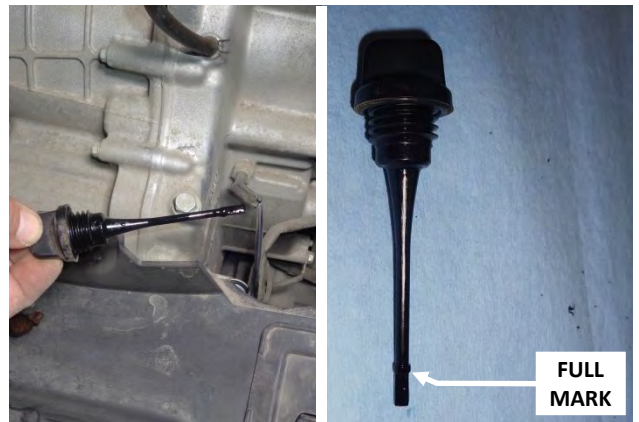

12. Remove the dipstick and verify the transmission oil is at the FULL mark. **If not, add oil until the transmission is FULL.**

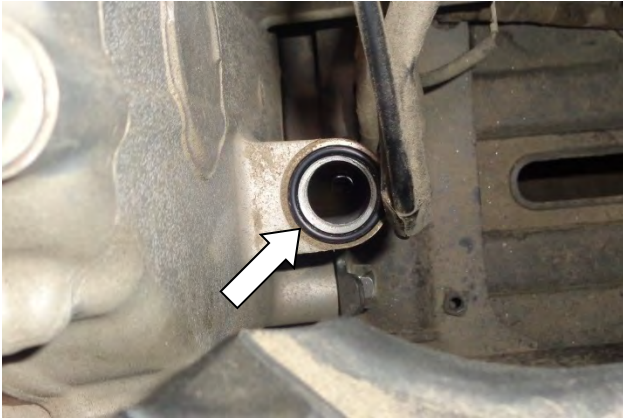

13. Verify that the filler cap o-ring came off of the transmission case along with the cap. If not, remove it from the case.



15. Install the dipstick tube (2) on the fitting and tighten the nut.



16. Choose your installation location. Your B&M remote dipstick is designed to be installed at one of two locations: **A. Suggested location:** The center console, forward of the parking brake lever.

#### INSTALL B&M DIPSTICK

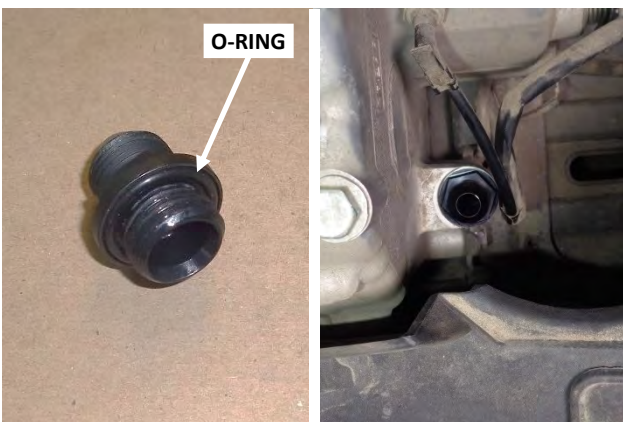

14. Verify that the o-ring is on the dipstick tube fitting (1), and install and tighten the fitting in the fill port.



**B. Alternate location:** Under the hood, behind the radiator.

**SUGGESTED LOCATION A: CENTER CONSOLE**



17. In the panel recess just forward of the emergency brake lever, lay the bracket (3) flat in the front right corner and mark the center of the hole.



18. Use a hole saw to bore a 3/4" hole through the panel, then deburr the edge of the hole.

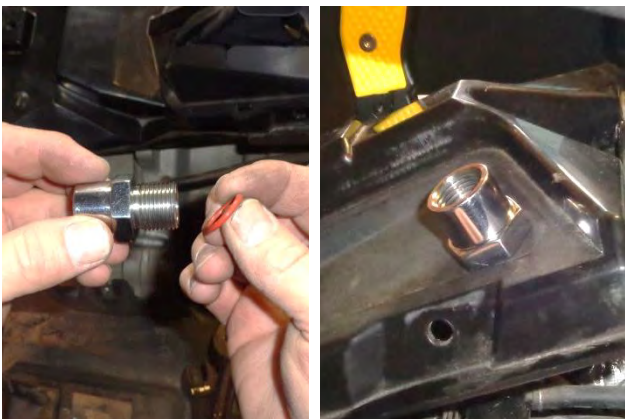

19. The o-ring on the dipstick adapter (4) is not used for this installation. Remove the o-ring, then place the adapter in the hole.



20. Route the tube behind the frame (to prevent interference when the side cover is reinstalled).



21. Slip the bracket over the back of the adapter, thread the tube nut onto the adapter, and tighten the tube and adapter. (The bracket only serves as a spacer, so its orientation is not critical.)

22. Wipe the dipstick assembly (5) with a clean, lint-free rag to remove any assembly oil residue, then install the dipstick in the tube and tighten the knob hand-tight (until the o-ring is fully compressed). **Proceed to Step 29.**

**ALTERNATE LOCATION B: UNDER THE HOOD**

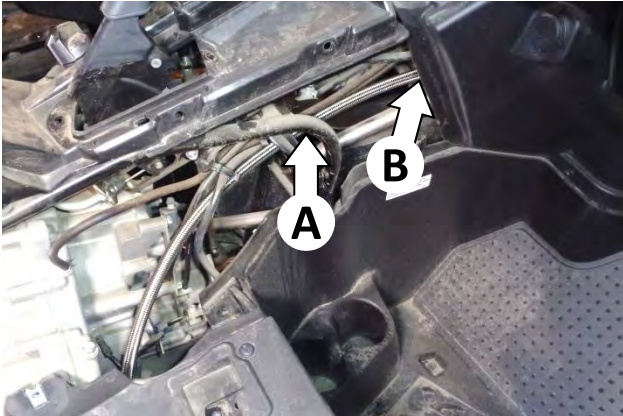

23. Route the tube behind the frame (A) and the side console panel (B), and toward the service compartment under the hood.



24. In the service compartment, locate the frame hole to which the dipstick bracket will be attached, and route the tube toward the hole.

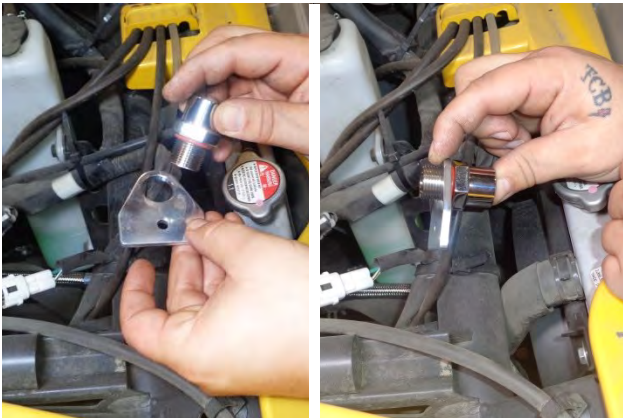

25. Slip the bracket (3) over the adapter (4). **NOTE: The o-ring on the adapter is required for this installation.**

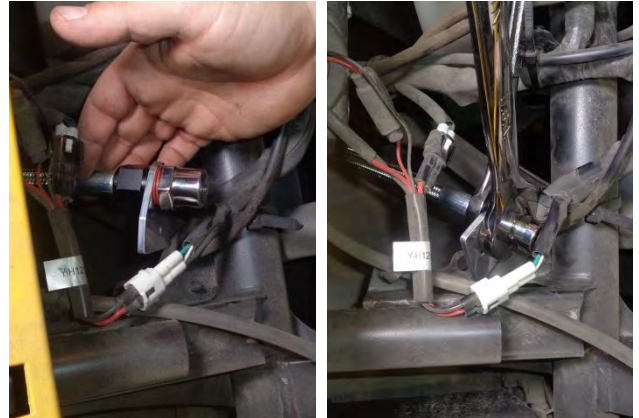

26. Thread the tube nut onto the fitting, and tighten the tube and fitting.



27. Fasten the dipstick bracket to the vehicle frame using the M6 screw (6) (on the bracket side), and the flat washer (7), lock washer (8) and nut (9) (on the frame side).

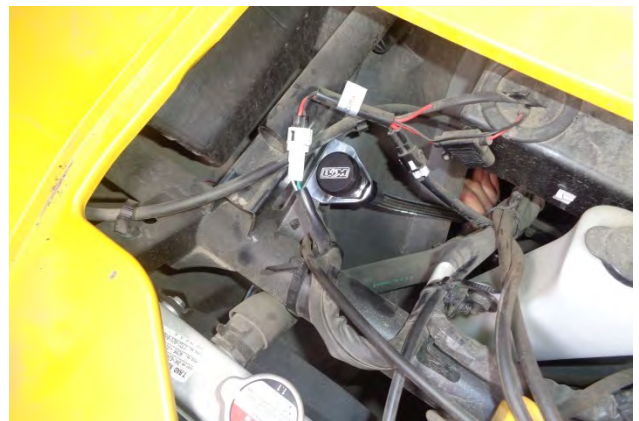

28. Wipe the dipstick assembly (5) with a clean, lint-free rag to remove any assembly oil residue, then install the dipstick in the tube and tighten the knob hand-tight (until the o-ring is fully compressed).

**TRANSFER OIL LEVEL MARKS FROM STOCK DIPSTICK TO B&M DIPSTICK**

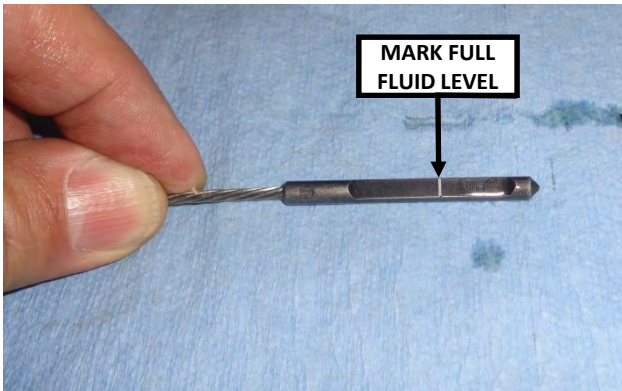

29. Remove the B&M dipstick, wipe it off, and reinstall it all the way (hand-tight). Then remove the dipstick again and permanently mark the fluid level with a scribe, hacksaw blade or needle file. **This is your dipstick's FULL mark.**

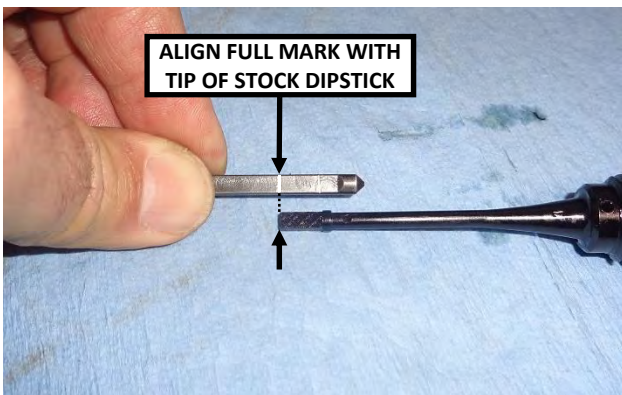

30. Lay the stock and B&M dipsticks next to each other, aligning the B&M dipstick's FULL mark with the tip of the stock dipstick.

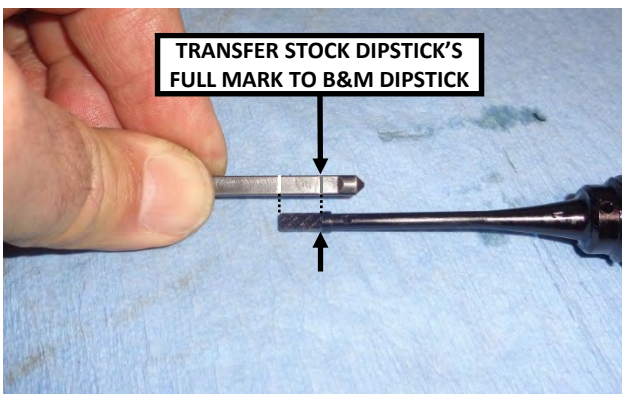

31. Transfer the stock dipstick's FULL mark to the B&M dipstick, using a scribe, hacksaw blade or needle file. **This is your dipstick's MINIMUM mark.**



32. Reinstall the dipstick and tighten the knob hand-tight.

**REASSEMBLE THE VEHICLE**

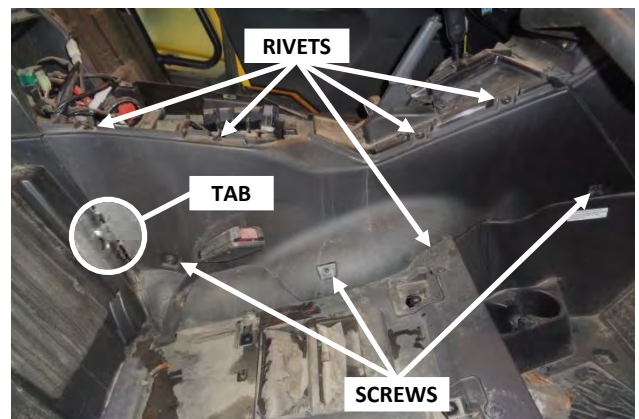

33. Reinstall the right console side cover. First insert the locating tab in its slot, then fasten the cover with its five plastic push rivets (four along the top and one at the bottom), and its three screws along the bottom.

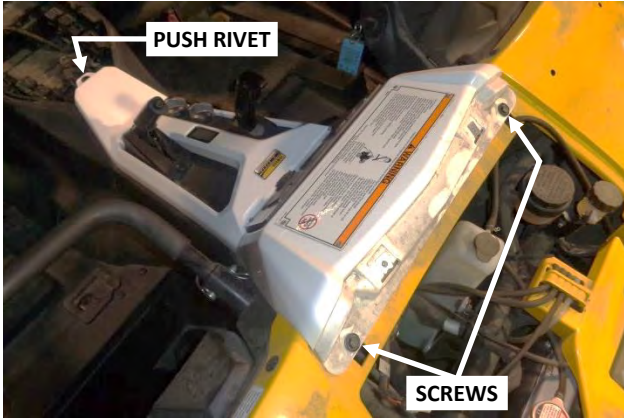

34. Reinstall the front console cover. Fasten it to the vehicle with the plastic push rivet at the rear, and the two screws at the front.

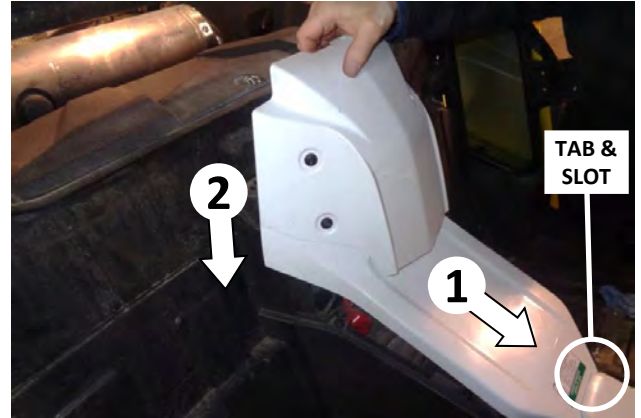

37. Reinstall the rear console cover by inserting the front locating tab into its slot, then firmly pushing the rear end down until the cover snaps into place.



35. Insert the four tabs at the front of the service cover into their respective slots and lay the cover in place.



38. Reinstall the seat back, fastening it to the vehicle with its four bolts.

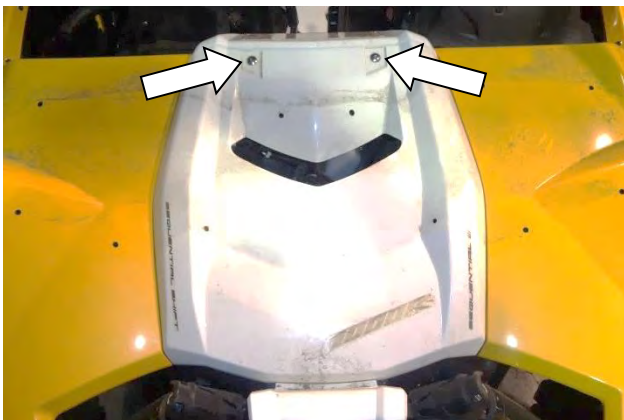

36. Fasten the service cover to the vehicle with its two screws.



41. Reinstall the seat cushion. First slip its rear tabs under the retaining rod, then push the cushion down firmly until its pin snaps into the grommet.





**Congratulations, the installation of your B&M Remote Dipstick is now complete!**

---

#### **ADDING TRANSMISSION OIL**

ONLY USE THE TRANSMISSION OIL SPECIFIED BY YOUR VEHICLE'S MANUFACTURER.

Add transmission oil through the dipstick adapter using a 3/8" O.D. rubber hose, and a pump or funnel. **Add oil slowly, checking often to avoid over-servicing.**

**IMPORTANT: RETAIN THESE INSTRUCTIONS FOR FUTURE REFERENCE**

