

TEXTRON WILDCAT XX

WINCH MOUNT

Winch Mount

PART # 101575

Hardware Kit: HK-349

Kit Components:

| Item # | Qty. | Description |
|--------|------|-------------------------------|
| 1 | 1 | WINCH MOUNT |
| 2 | 1 | FAIRLEAD MOUNT |
| 3 | 1 | 90 DEG CONTACTOR MOUNT |
| 4 | 2 | 3/8"-16 X 1.50 X 2.50 U-BOLT |
| 5 | 4 | 3/8"-16 X .75 HEX BOLT FLANGE |
| 6 | 4 | 3/8"-16 HEX NUT FLANGE NYLOCK |
| 7 | 2 | 1/4" FLAT WASHER |

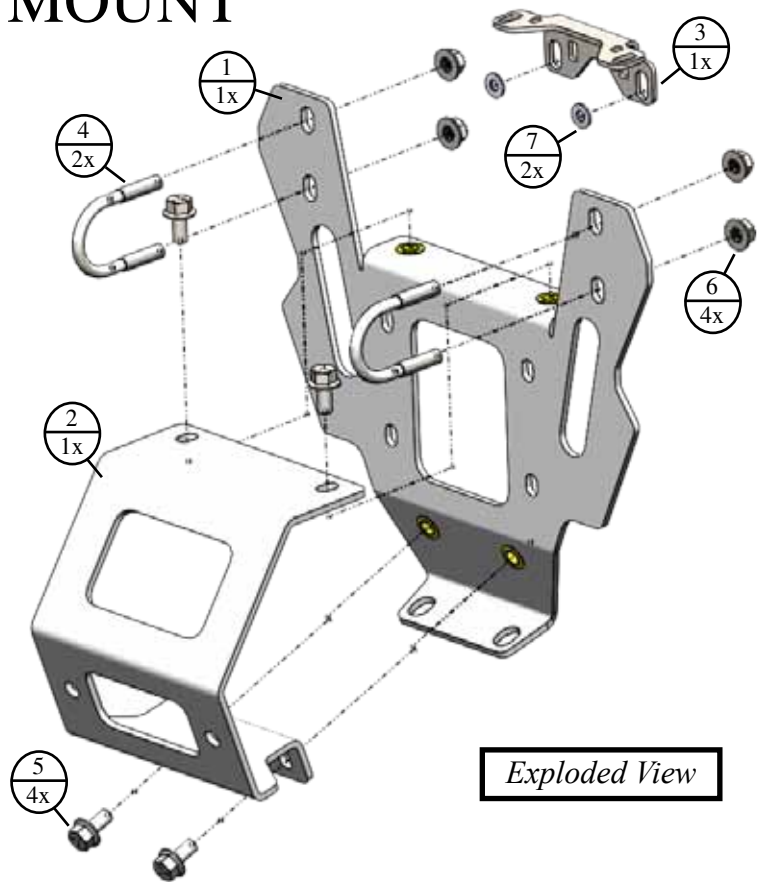

INSTALLATION INSTRUCTIONS:

Note: Read through and understand the instructions before installing. This install will require cutting your grill.

1. Remove the front plastics from your machine shown in Figures 1 & 2. Set hardware aside for later.
2. There will be a plastic cover that you will need to remove, and discard in location (A) in Figure 3. (Plastic cover already removed in example photo)
3. Place a piece of cardboard (B) over the radiator to



Figure 1

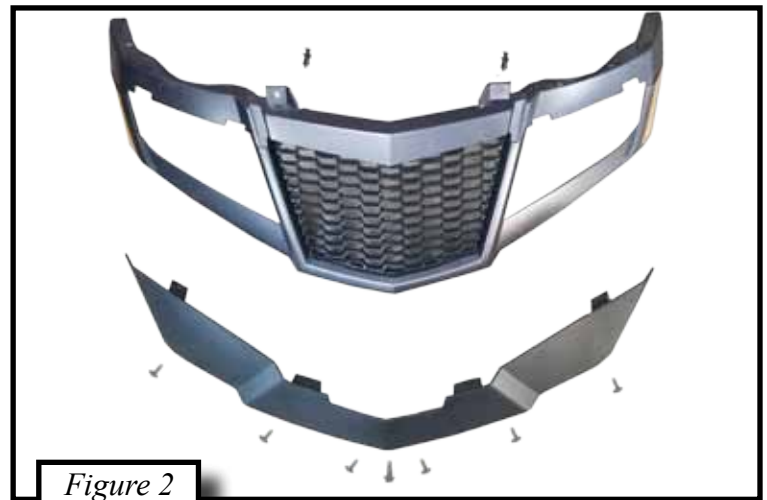

Figure 2

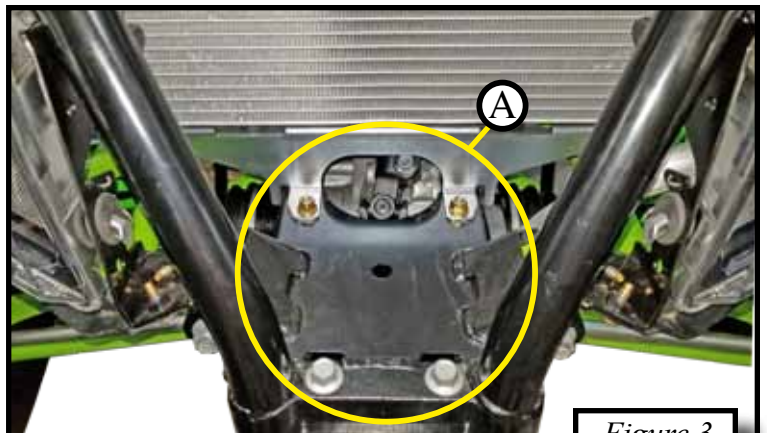
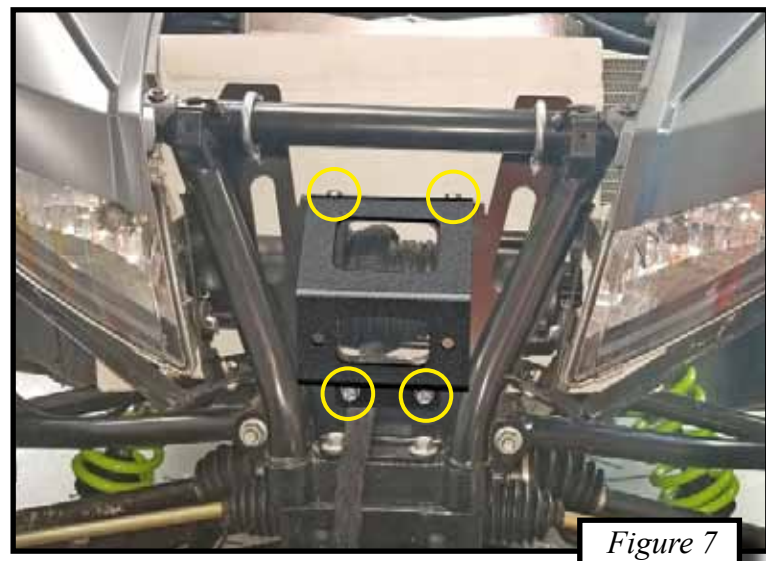
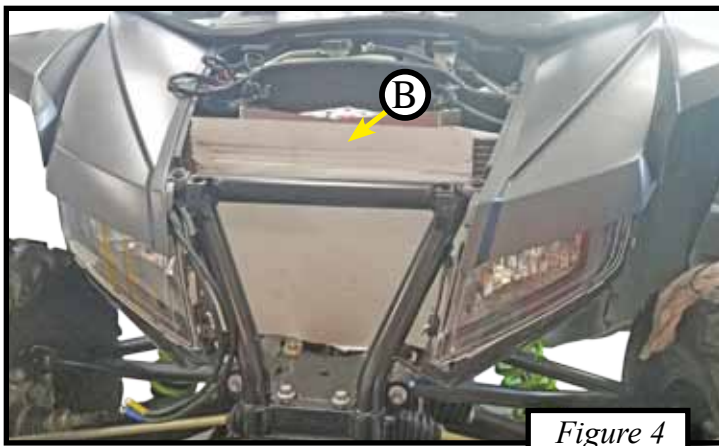
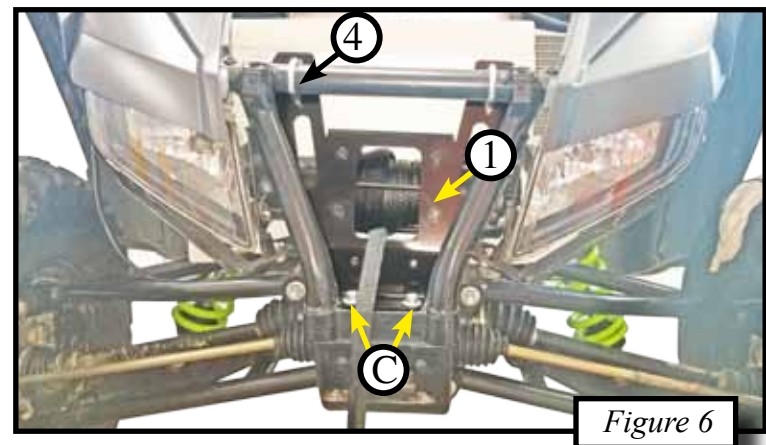
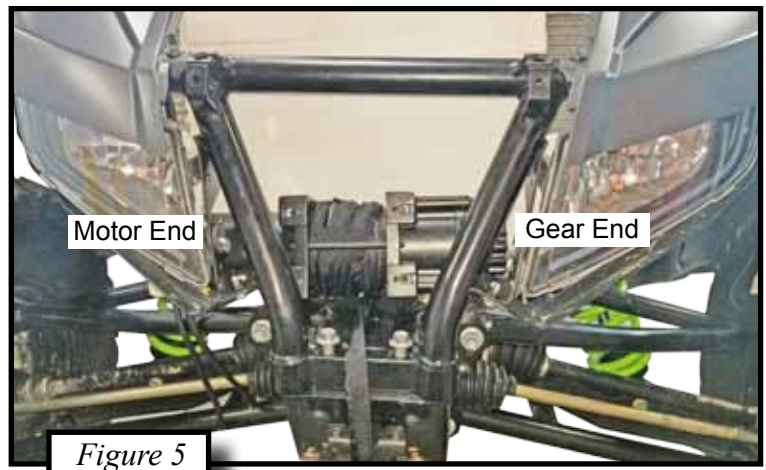

Figure 3

protect it while you are installing the winch. Shown in [Figure 4](#).

4. Set winch down between the front bumper and the radiator shown in [Figure 5](#). The winch is not attached to anything at this point. Make sure you have the correct orientation of the winch.
5. Place the winch mount (1) down in front of the winch facing the bumper shown in [Figure 6](#). Remove the two bolts (C) from the frame. (*DO NOT MOVE MACHINE WITH BOLTS REMOVED.*)
6. Attach the winch mount to the inside of the frame using the two bolts (C) previously removed and U-bolts (E). Shown in [Figure 6](#).
7. Bolt the winch up to the winch mount using the hardware that came with your winch. Shown in [Figure 6](#). Make sure that the rope is running off the bottom of the spool.
8. Attach the fairlead bracket up to the winch mount using the four 3/8" bolts (5) into the riv-nuts. Shown in [Figure 7](#). Then attach the roller fairlead provided with the winch to the bracket using the hardware supplied with the winch .



9. To make room for the fairlead rollers and cable you will need to cut your plastic grill. Use [Figure 8](#) as a guide on what to cut out. Count the holes from the edge and mark out your cutting line.

10. Re-install the all the front plastics previously removed.



Figure 8

Winch Wiring

1. The contactor location is under the center console next to the battery.
2. You need to first remove the drivers seat and then you can remove the center console to gain access to the battery.
3. The contactor comes with four bolts to mount up. Attach the contactor to the contactor bracket using two of the mounting bolts. Using the two flange washers (7) and remaining contactor hardware attach the bracket to the battery tray. Shown in [Figures 9 & 10](#).
4. You will run the longer winch wires up through the center console to the front of the machine.
5. For more details on wiring the winch see your winch manual.

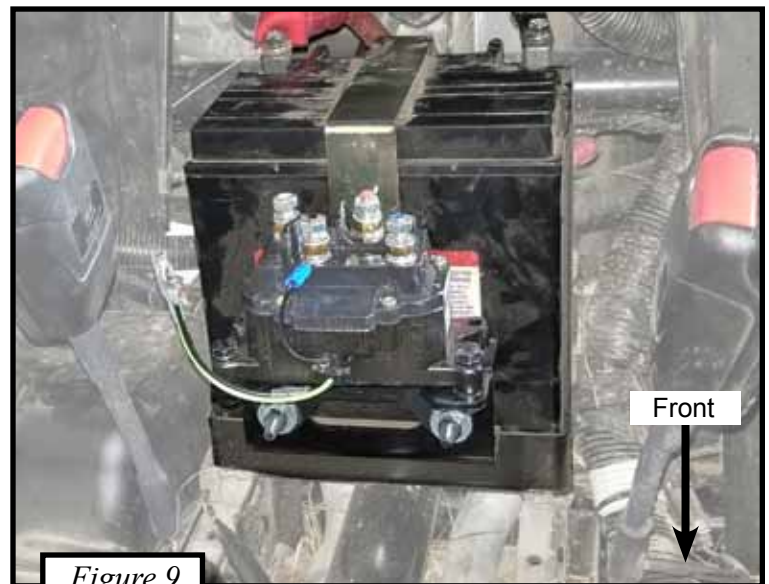

Figure 9

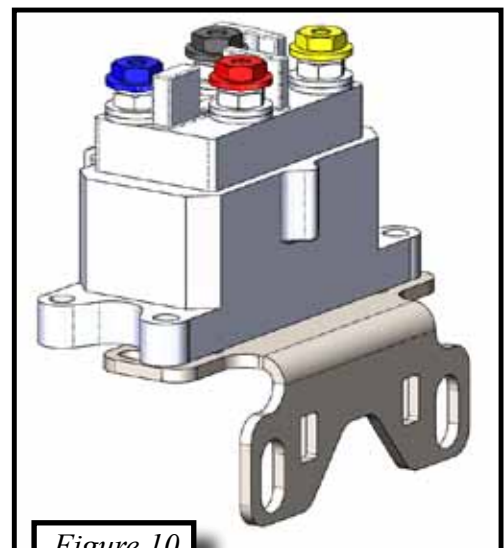

Figure 10

