

KLAMATH TAIL RACK PACK™

Like a tank bag for the rear of the bike — keeps gear organized and easily accessible, securing to virtually any motorcycle tail rack.



- Compatible with a broad spectrum of motorcycle makes/models and tail rack designs
- Integrates with Giant Loop's MoJavi™ Saddlebag
- Zipperless quick access lid
- Includes two 25-inch Pronghorn Straps™, two Fender Hooks and two webbing straps for multiple mounting options
- Interior adjustable divider with pen/tire pressure gauge loop
- Includes removable Dry Pod™ waterproof liner
- Many other rider friendly features

⚠ WARNING: This product can expose you to chemicals including DBP and DEHP which is known to the State of California to cause cancer and birth defects or other reproductive harm. For more information go to www.P65Warnings.ca.gov.

**4
LITERS**

**PACKABLE
VOLUME**



GO LIGHT. GO FAST. GO FAR.





See giantloopmoto.com/warranty for complete warranty details.



NOTE: Before mounting, carefully read through these instructions. Failure to follow recommended mounting instructions voids warranty. Manufacturer is not liable for any damage, injury or death that results from improper use and installation of products. By installing this product, user accepts all liabilities, terms and conditions outlined in the Liability & Warranty statement included here.

Mounting Instructions

MOUNTING USING GL TAIL RACK

For easier installation, remove lid, divider and Dry Pod.

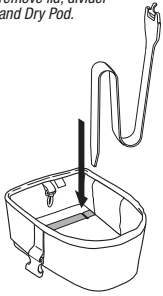

Straps longer than actual size here for illustrative purposes.

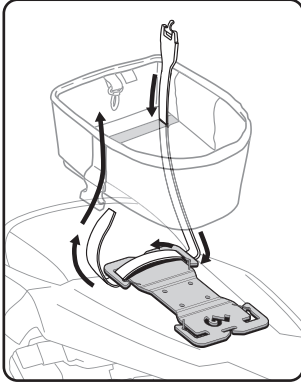

For best compatibility with Klamath, position GL Tail Rack lengthwise. Thread Pronghorn Strap, small end down, through the slot on the bottom of Klamath. Pass the strap through the carabiner clip slots on the tail rack, then back through the opposite slot on Klamath. Repeat for second strap.

NOTE: This method works with virtually every tail rack.

MOUNTING USING FENDER

For easier installation, remove lid, divider and Dry Pod.

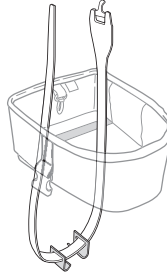

Straps longer than actual size here for illustrative purposes.

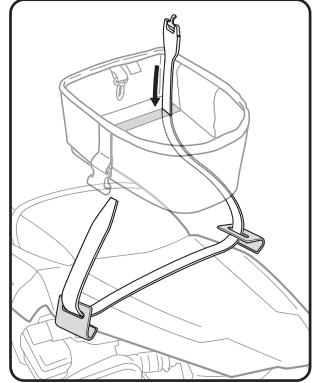

Thread Pronghorn Strap, small end down, through the slot on the bottom of Klamath. Slide on two fender hooks, facing each other as shown. Position Klamath as desired, secure hooks on either side of fender. Repeat for second strap.

! When using fender hooks, always mount Klamath with at least one redundant tether to prevent it from separating from bike.

SECURING ANCHOR STRAPS

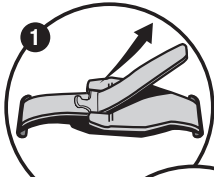

1 Push strap end through aluminum fastener.

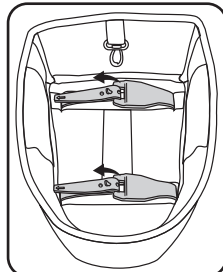
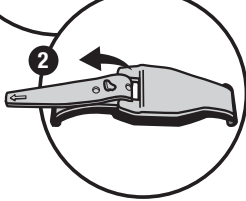

Pull to apply tension by stretching Pronghorn Strap slightly, and secure on fastener "prong."

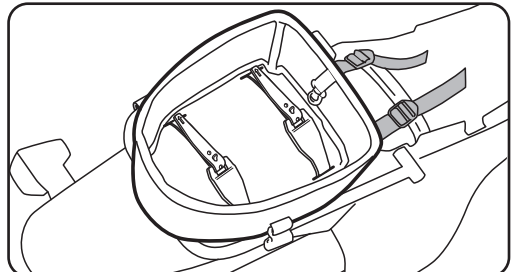

Remove webbing straps if not needed, or use them to apply forward tension on fender hooks. Re-attach lid and insert included divider and waterproof Dry Pod.

! Ride a short distance and re-tension anchor straps. Check and re-tighten all straps at stops, as gear can shift and compress.

PACKING AND CARE TIPS

- The pack's outer Bomb Shell™ is adventure proof - not waterproof. Pack moisture-sensitive gear in included waterproof Dry Pod.
- Go light! Do not overstuff or over pack. Avoid packing heavy objects above seat height and behind rear axle.
- Pack hard, sharp or metallic gear in protective wrappers and/or sleeves. Also protect from contact with other solid objects that may abrade fabric such as hard metal rack surfaces.
- Divider can be repositioned or removed. Use foam block or shock-resistant case to protect camera equipment or other delicate gear.
- Avoid exposure to chemicals that may degrade fabric, such as insect repellents containing DEET.
- Hand wash with mild soap and warm water. Hang to air dry. DO NOT MACHINE WASH.

0520



www.giantloopmoto.com | 888-358-8347 | Bend, Oregon USA

GO LIGHT. GO FAST. GO FAR.