

# Kawasaki

## Assembly Instructions

Model:	ZR900C/E
Description:	Slider
Part Number:	99994-1010
Flat Rate Time(Hr):	0.3

**Before you begin, read through these instructions and check that all parts are present. Please note that Kawasaki cannot assume any responsibility for damage resulting from incorrect installation.**

**Kawasaki recommends that all genuine accessories should be fitted by an authorized Kawasaki dealer.**

The following symbols indicate the information for proper installation and operation in this instruction.

**NOTE** : *NOTE indicates information that may help or guide you in the operation or service of the vehicle.*

● Indicates a procedural step or work to be done.

○ Indicates a procedural sub-step or how to do the work of the procedural step it follows. It also precedes the text of a NOTE.

Parts List				
No.	Component Name	Part No.	Qty	Remark
1	O-ring	92055-0885	2	φ11 mm (0.4 in.)
2	Collar	92152-2335	2	φ16 mm (0.6 in.)
3	O-ring	92055-0884	2	φ15.8 mm (0.6 in.)
4	Collar	92152-2334	2	φ22 mm (0.9 in.)
5	Nut	92015-1757	4	
6	Bracket	11057-0922	1	Left, "ACC-0105" Mark
7	Bracket	11057-0923	1	Right
8	Bolt	130CB0614	2	L = 14 mm (0.6 in.)
9	Collar	92152-2435	1	Left, L = 30.7 mm (1.2 in.)
10	Pad	39156-2123	1	Left
11	Pad	39156-2124	1	Right
12	Collar	92152-2436	1	Right, L = 28.5 mm (1.1 in.)
13	Bolt	130CB0620	2	L = 20 mm (0.8 in.)
14	Bolt	92153-1931	2	L = 65 mm (2.6 in.)
15	Cover	14093-0516	1	Left
16	Cover	14093-0517	1	Right
17	Bolt	92154-2669	4	

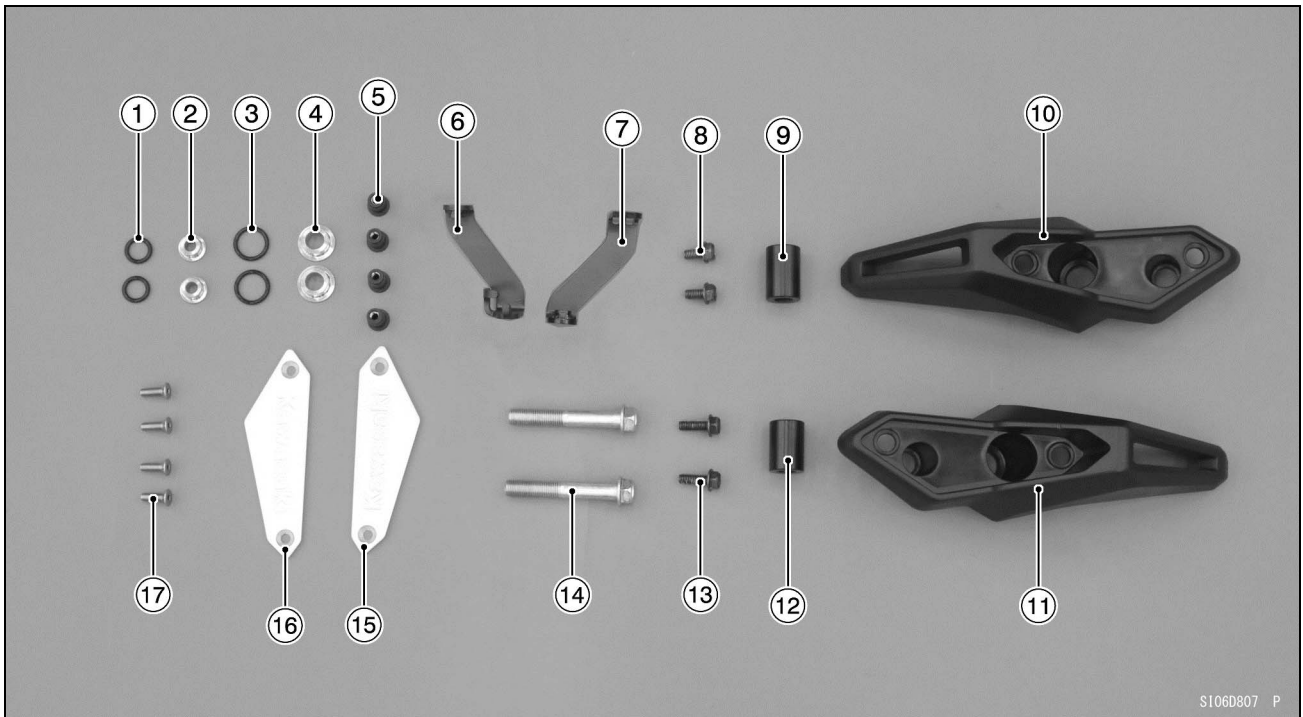

S106D807 P

### Installation Instructions

- Insert the O-ring [1] to the collar [2].
- Insert the O-ring [3] to the collar [4].

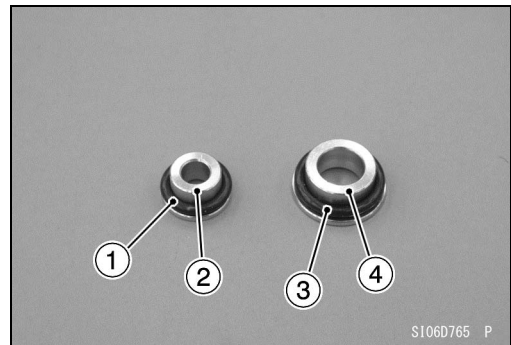

S106D765 P

- Install the nuts [5].
- Install the collars [2] [4].

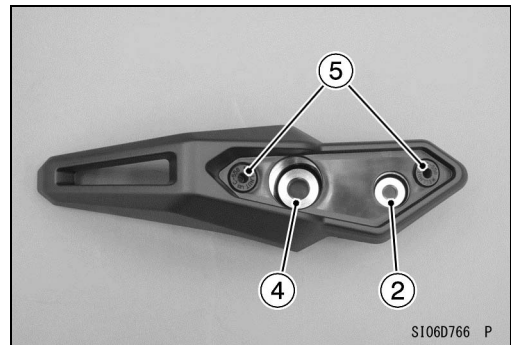

S106D766 P

### Assembly Procedure For Left Side

- Remove:
  - Left Middle Front Engine Mounting Bolt [A]
  - Left Middle Engine Bracket Bolts [B]
  - Left Middle Engine Bracket [C]

### NOTE

- This left middle front engine mounting bolt is not necessary for this accessory.

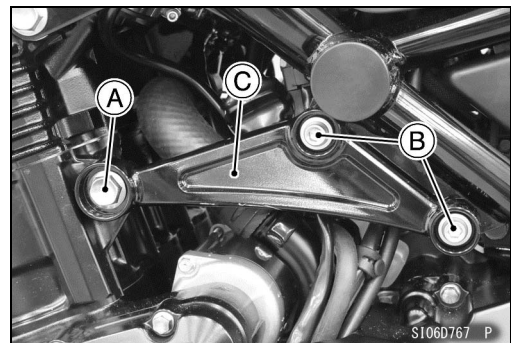

S106D767 P

## Installation Instructions

- Install the bracket [6] as shown, and tighten the bolt [8].

### NOTE

- This left bracket have a "ACC-0105" mark and the right bracket have a no mark.

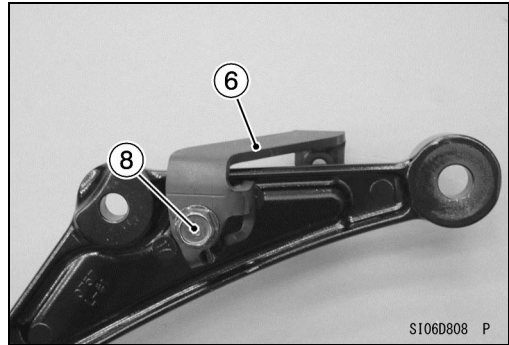

- Install the left middle engine bracket [A] and tighten the left middle engine bracket bolts [B] temporarily.

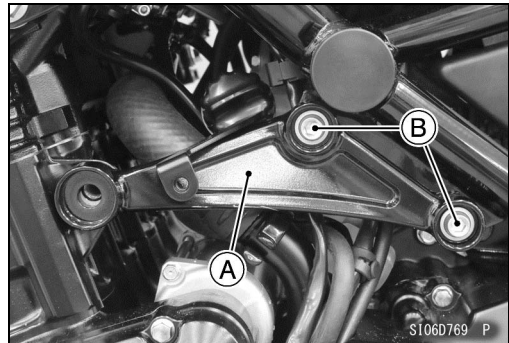

- Install:
  - Collar [9]
  - Pad Assy [A]
  - Bolt [13]
  - Bolt [14]

- Tighten:

**Torque – Bolt [14]: 45 N·m (4.6 kgf·m, 33 ft·lb)**  
**Left Middle Engine Bracket Bolts [B]: 25 N·m (2.5 kgf·m, 18 ft·lb)**

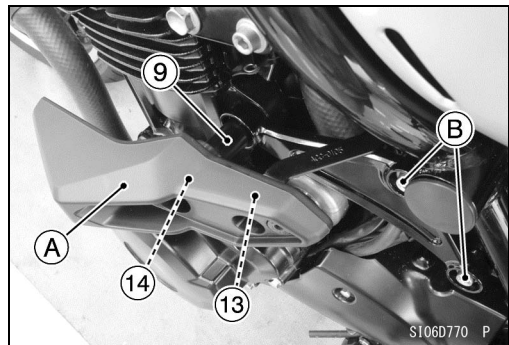

- Install:
  - Cover [15]
  - Bolt [17]

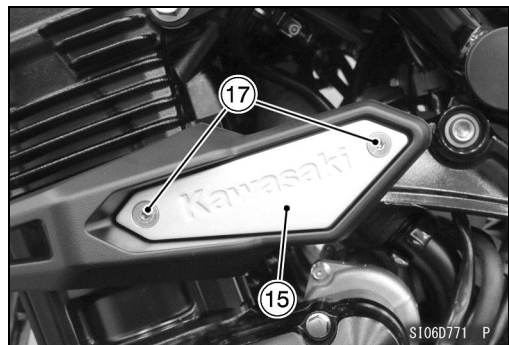

### Assembly Procedure For Right Side

### NOTE

- The right side slider installation is the same as left side, note the following.

- Install the bracket [7] as shown, and tighten the bolt [8].

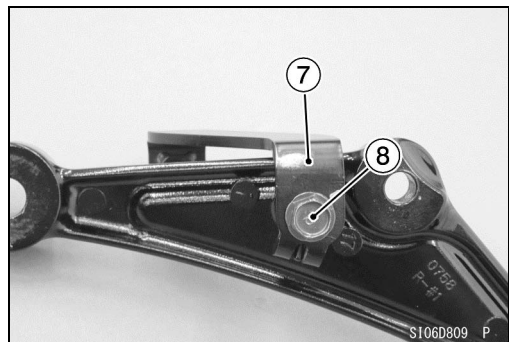

### Basic Torque for General Fasteners

The tables below, relating tightening torque to thread diameter, lists the basic torque for the bolts, nuts and screws. Use these tables for the bolts, nuts and screws which are not specified the tightening torque particularly on the previous pages. All of the values are for use with dry solvent-cleaned threads.

#### For Bolts and Nuts

Threads dia. (mm)	Torque		
	N·m	kgf·m	ft·lb
5	4.5	0.46	40 in·lb
6	8.0	0.82	71 in·lb
8	20	2.0	15
10	35	3.6	26
12	60	6.1	44

#### For Screws, Plastic Part Tightening Portions and Plastic Washer Tightening Portions

Threads dia. (mm)	Torque		
	N·m	kgf·m	ft·lb
4	1.2	0.12	11 in·lb
5	3.0	0.31	27 in·lb
6	4.0	0.41	35 in·lb

#### For Self-Tapping Screws

Threads dia. (mm)	Torque		
	N·m	kgf·m	ft·lb
All	1.2	0.12	11 in·lb

#### For Wellnuts

Threads dia. (mm)	Torque		
	N·m	kgf·m	ft·lb
4	0.2	0.02	1.8 in·lb
5	0.5	0.05	4.4 in·lb
6	1.0	0.10	8.9 in·lb

**Check tightness of all fasteners in regular interval. Retighten loose fasteners.**