



KAOKO™ CRUISE CONTROL KIT

CAN-AM Spyder Models

CAN100 : for 18-8mm to 17.7mm ID Bars (Approx. 1999 to Approx. 2011/2)
 CAN100S : for 17.7mm to 17.4mm ID Bars (Approx. 2011/2 — 2013, Spyder Roadster)
 CAN200 : Spyder ST & Spyder RT (2013—current)

SABS

DESIGN
EXCELLENCE
AWARDS
2009

RSA Registered Designs			
No. A2007/00202	No. A2007/00205		
No. A2007/00203	No. A2007/00206		
No. A2007/00204	No. A2007/00207		

USA Patents
 "U.S. Pat. No. US D593,462 S"
 "U.S. Pat. No. US D593,463 S"
 "U.S. Pat. No. US D593,464 S"



1
 Spyder End Cap Removed
 (only CAN100 & CAN100S)



2
 Plastic Thrust
 Washer Fitted



3

Friction Nut
 Grub Screw
 Thrust Washer



4
 CAN100/S
 KAOKO™ KIT

Spigot &
 Wedge Nut

2mm

KAOKO Kit
 Comprises of :

- End Weight,
- Friction Nut,
- Thrust Washer,
- 2mm Allen key,
- Fitting Instructions

DISCLAIMER: NO RESPONSIBILITY ACCEPTED FOR NON-ADHERENCE TO THESE INSTRUCTIONS

KAOKO™ Safety Warning:

See: www.kaoko.com; for further information info@kaoko.com

The KAOKO™ Cruise Control is an aftermarket accessory. Any misunderstood, abused or incorrectly installed motorcycle accessory is a safety hazard that could cause injury or death. It's the rider's responsibility to understand the operation and purpose for which the KAOKO™ Cruise Control is designed, namely, for cruising, only when safe to do so. At all other times the control should be disengaged. The KAOKO™ Cruise Controls are to be used only by experienced and responsible riders.

Note: An adjustment to throttle assembly position may be necessary to suit KAOKO™ Cruise Controls. The throttle assembly position on aftermarket bars, and some OEM bars, is adjustable. The assembly can marginally be re-positioned along the handle bars slightly loosening the throttle assembly clamp screws, and then sliding the throttle assembly along the handle bars (left or right). Once done, firmly tighten the clamp screws to OEM torque specifications. This adjustment is generally not necessary.

Fitting & Operating Instructions:

Step 1: CAN100 & CAN100S : Completely remove the right hand side bar end plug as shown in picture 1. Adjust the Friction Nut so that the 2mm gap, as shown in picture 4, is at a minimum.

Note: a copper shim is included in the CAN100 and CAN100S kits. This shim is to be fitted around the Spigot and Wedge Nut (see picture 4 above). The copper shim is only necessary on rare fitting assemblies where the control does not secure tightly to the handle bars (ID) on final assembly — after firmly tightening the central retaining bolt.

CAN200 : Completely remove the right hand side bar end weight. The handle bar threaded insert will be visible. Adjust the Friction Nut so that 2mm gap as shown in picture 4 is at a minimum.

Step 2: CAN100 & CAN100S : Place the Kaoko™ plastic thrust washer onto the end of throttle as shown in Picture 2. The spigot on the one face of the thrust washer must thrust against the end of the throttle sleeve. When fitting the thrust washer, it is necessary to stretch the rubber sleeve over the spigot of the thrust washer.

Note: CAN100 is sometimes supplied with a copper shim which fits over the spigot and wedge nut of the CAN100 control. See picture 4 above. This shim is to be fitted when additional material (diameter) is required allowing a proper lock inside the ID of the handle bars.



Figure 1—CAN200

CAN200 : Place the flat Kaoko™ plastic thrust washer onto the body of the kit and fit per Step 3 below.

Step 3: CAN100 & CAN100S : Slide the KAOKO™ Kit fully into end of handle bar, up against the thrust washer, as shown in picture 3 and firmly tighten the central retaining screw.

CAN200 : Slide the KAOKO™ Kit fully into end of handle bar, up against the thrust washer, as shown in picture 3 and firmly tighten the central retaining screw. Note: the CAN200 Kit will be fastened to the threaded insert inside the Internal Diameter of the handle bar tube.

Note: a 1mm thick M6 bright steel washer is included in CAN200 kit and for rare fitting assemblies where insufficient clearance between the friction nut and throttle sleeve exists. This is noticed when binding occurs on final assembly. In this event, fit the bright washer onto the central retaining bolt. The bright washer must locate in-between the recess of the bar weight and the threaded insert inside the handle bar tube. This bright washers is generally not required for successful installation.

Step 4: CAN100 & CAN100S : Back off the friction nut against the shoulder of the bar weight to disengage the Throttle Control.

CAN200 : After firmly tightening the central retaining screw (Step 3); the KAOKO™ control should be in the completely disengaged Position (normal throttle functionality). To engage see notes below. See Figure 1 above for CAN200 final assembly.

Step 5 : Set Friction Nut to desired resistance by gently tightening the grub screw (see picture 4) with 2mm Allen Key. Friction nut should be slightly stiff turning.

Operation: The friction nut has a **left hand thread**. In readiness for engagement it must be adjusted so that it makes light contact with the plastic thrust washer.

To Engage: While rolling on the throttle, the friction nut can be gripped between the small finger and palm of hand. This action tightens the nut and provides sufficient friction to set throttle to the desired opening.

(The friction is such that the rider may still open and close the throttle. It simply has a slight stiffness to it.)

To Disengage: While rolling off the throttle, grip friction nut between small finger and palm of hand.

VERY IMPORTANT! The throttle should open and snap closed freely when correctly disengaged.

Note: The Grub Screw is set to provide the necessary resistance on thread of friction nut. This may be adjusted periodically to take up wear.

Maintenance: Remove kit annually. Unscrew friction nut and brush clean threads with mild soap. Apply petroleum jelly to threads and assemble. Adjust grub screw per Step 5 above. (O-Ring cushion: 19.6mm I.D. x 2.4mm section — if replacement is required)

Indemnity:

It is advised that the use of the cruise control is at the sole risk of the rider and by his/her decision to use it he/she does indemnify the manufacturers or organizers, their agents, employees and officers against any claim or action by themselves, their dependants or any other third party arising out of any loss, damage, injury or death suffered.

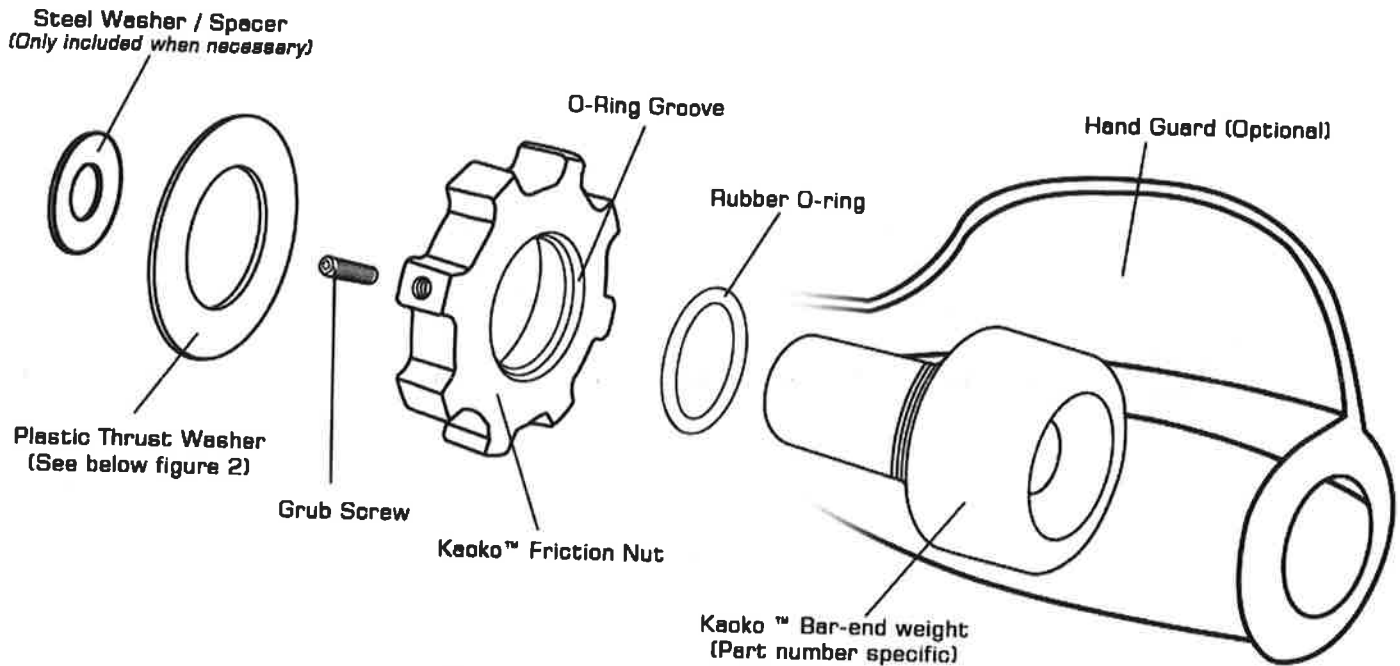
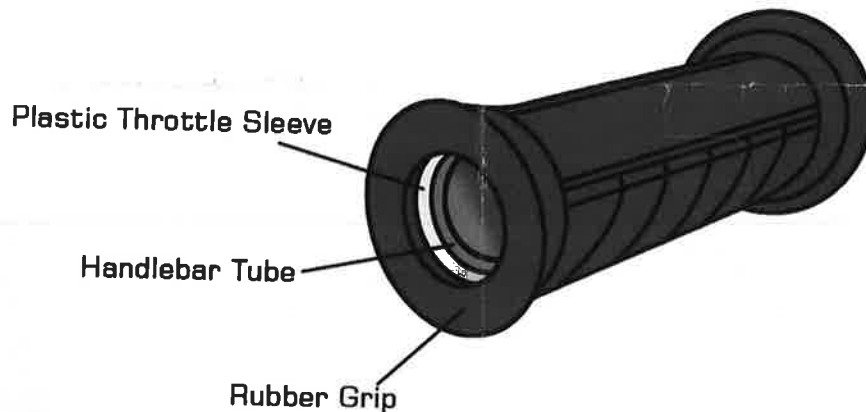

Figure 2: Thrust Washer Final Fitment

Note: The KAOKO™ Thrust Washer (*ref: figure 1*) must *thrust* against the plastic throttle sleeve (*tube*) indicated below in figure 2.

The KAOKO™ Thrust Washer must not thrust against the rubber throttle grip. Refer detailed instructions on reverse.



KAOKO™ ACCESSORIES AND PRODUCTS

Express Disclaimer, Exclusion of Liability, Indemnity and Safety Warning:

1. The accessories and products supplied by KAOKO™ are aftermarket accessories and products.
2. The use and employment of such accessories and products is at the sole risk and discretion of the user.
3. The user of such accessories and products further indemnifies KAOKO™ and its representatives against all claims and losses arising (including personal injuries, death, damage to property and any other losses) and involving such accessories and products.
4. KAOKO™ provides no warranty on accessories and products that it produces and distributes and does not aver that these accessories and products are fit for the purposes for which same are manufactured and intended.
5. KAOKO™ assumes no responsibility for and liability regarding any and all defects, deficiencies or otherwise in and attributed to its motor accessories and products.
6. KAOKO™ further assumes no responsibility for and liability regarding any prospective losses and claims for damages; be same actual, consequential or contingent and which in any way are associated with its motor accessories and products. In circumstances where accessories and products supplied are found to be of defective manufacture, KAOKO™ reserves its rights to replace such defective accessories and products, alternatively; effect a financial refund equivalent to the purchase price of such accessories and products as at the date of placement of order.
7. The application and affixing of KAOKO™ accessories and products to vehicles may necessitate or result in modifications being undertaken and this may result in manufacturer or otherwise warranties provided on such vehicles being affected and for that matter voided. In circumstances where the above occurs, KAOKO™ expressly denies being accountable regarding any liability and losses ensuing.
8. The application and affixing of KAOKO™ accessories and products may further result in usual vehicle operations and safety features being modified, override and for that matter discarded.
9. KAOKO™ accessories and products ought to be used by experienced and responsible riders only. The onus rests on the user of such KAOKO™ accessories and products to become properly familiarised with and understand the nature, operation and scope of the above accessories and products and further ensure that same are correctly affixed and used at all times and further not abused.
10. **Misapplication and abuse of such accessories and products can endanger the user and result in injury or death and further constitute safety hazards.**
11. The affixing and usage advices provided by KAOKO™ are for guidance purposes only and do not constitute specific fitment instructions. The onus rests on the user to ascertain and ensure proper and professional affixing and fitting to vehicles of the accessories and products and in seeking suitably qualified assistance in dealing with the above.
12. Prior to resorting to using KAOKO™ accessories and products, it is recommended that the user seek independent advice regarding the integrity and suitability of above accessories and products and in fulfilling the user's needs.
13. KAOKO™ accessories and products should only be fitted to new motorcycles and those that are in original condition, having not been involved in any accidents, being dropped, damaged or the subject of repair. Where KAOKO™ accessories and products are fitted to motorcycles not in original condition there is the risk that the operation of KAOKO™ accessories and products will be compromised and damaged. **In all of the above events, KAOKO™ does not accept liability.**