

# RS681 INSTRUCTIONS

TO BE INSTALLED BY A CERTIFIED MECHANIC ONLY | FOR RACE USE ONLY

## BRAKE SIDE EXPLODED VIEW

FOR: YAMAHA R1 09+ ADJUSTABLE



### INDEX

- Lubricate
- Red Thread Lock
- DO NOT Overtighten
- Use Factory Piece

### OPTIONAL HEAT SHIELD MOUNT

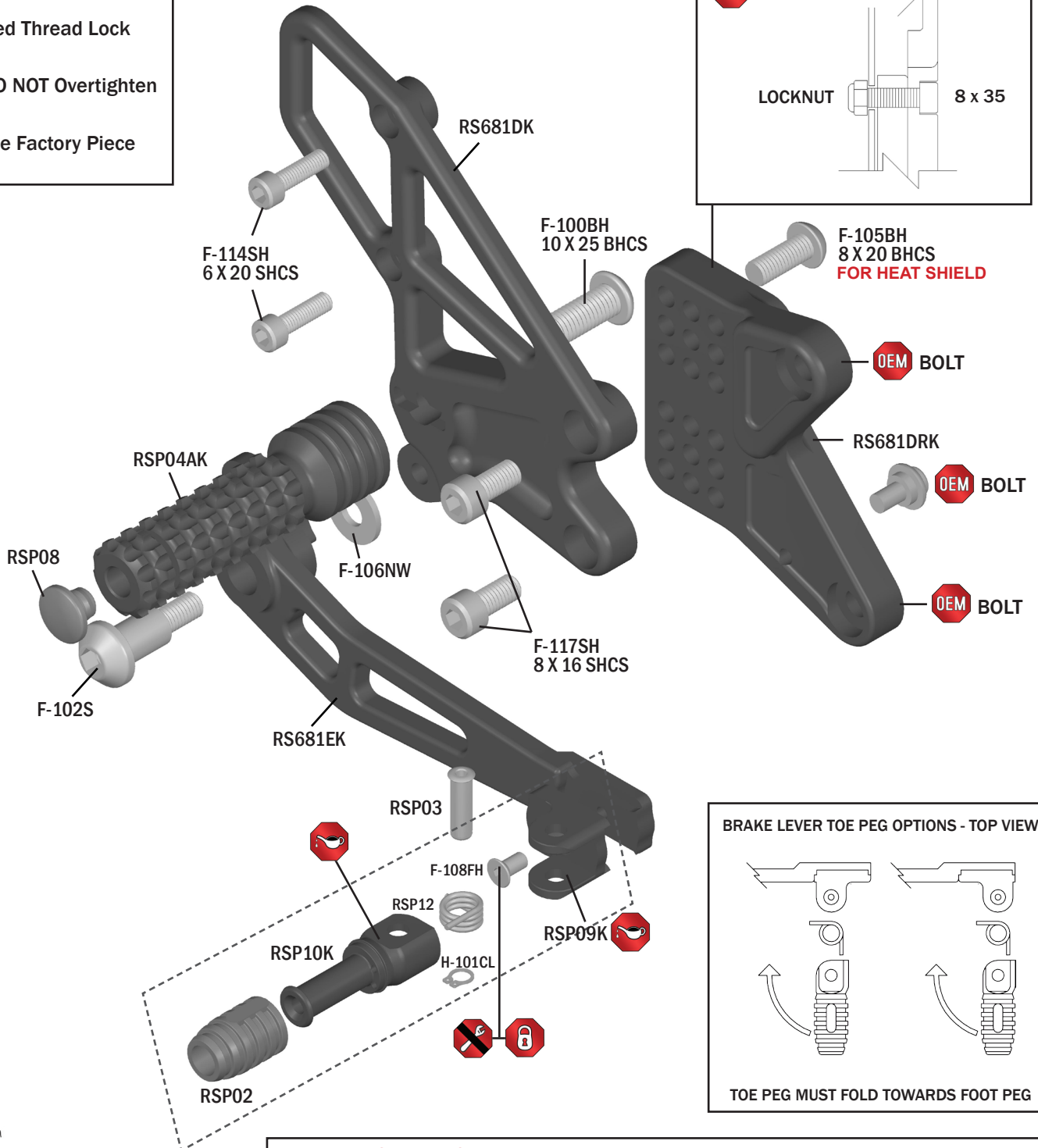
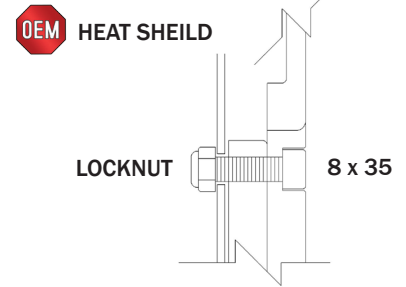

### BRAKE LEVER TOE PEG OPTIONS - TOP VIEW

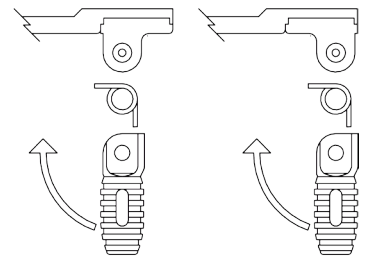

TOE PEG MUST FOLD TOWARDS FOOT PEG

### BRAKE LIGHT INFO:

These rearsets do not use: OEM rear brake light switch, spring & lever return spring. In race form these rear sets no longer activate rear brake light from rear brake lever. Street use requires rear brake light to be activated by rear & front brake levers. To achieve rear brake light activation from rear brake lever use Vortex in-line pressure switch RS100.



# RS681 INSTRUCTIONS

TO BE INSTALLED BY A CERTIFIED MECHANIC ONLY | FOR RACE USE ONLY

## SHIFT SIDE EXPLODED VIEW

FOR: YAMAHA R1 09+ ADJUSTABLE

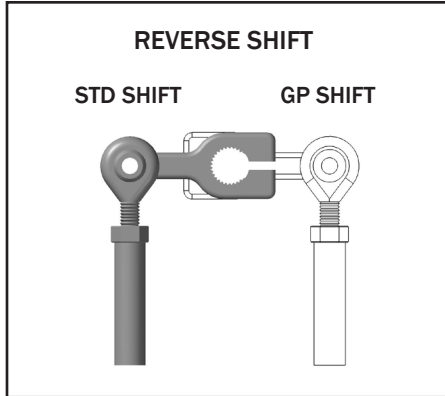

**INDEX**

- Lubricate
- Red Thread Lock
- DO NOT Overtighten
- Use Factory Piece

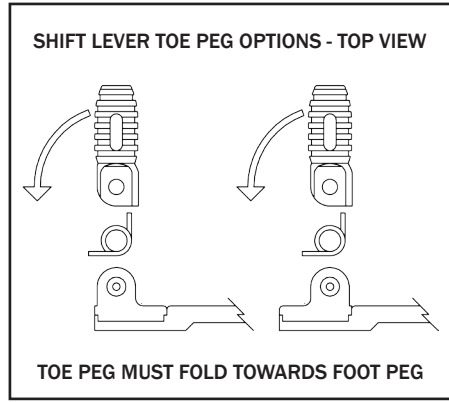
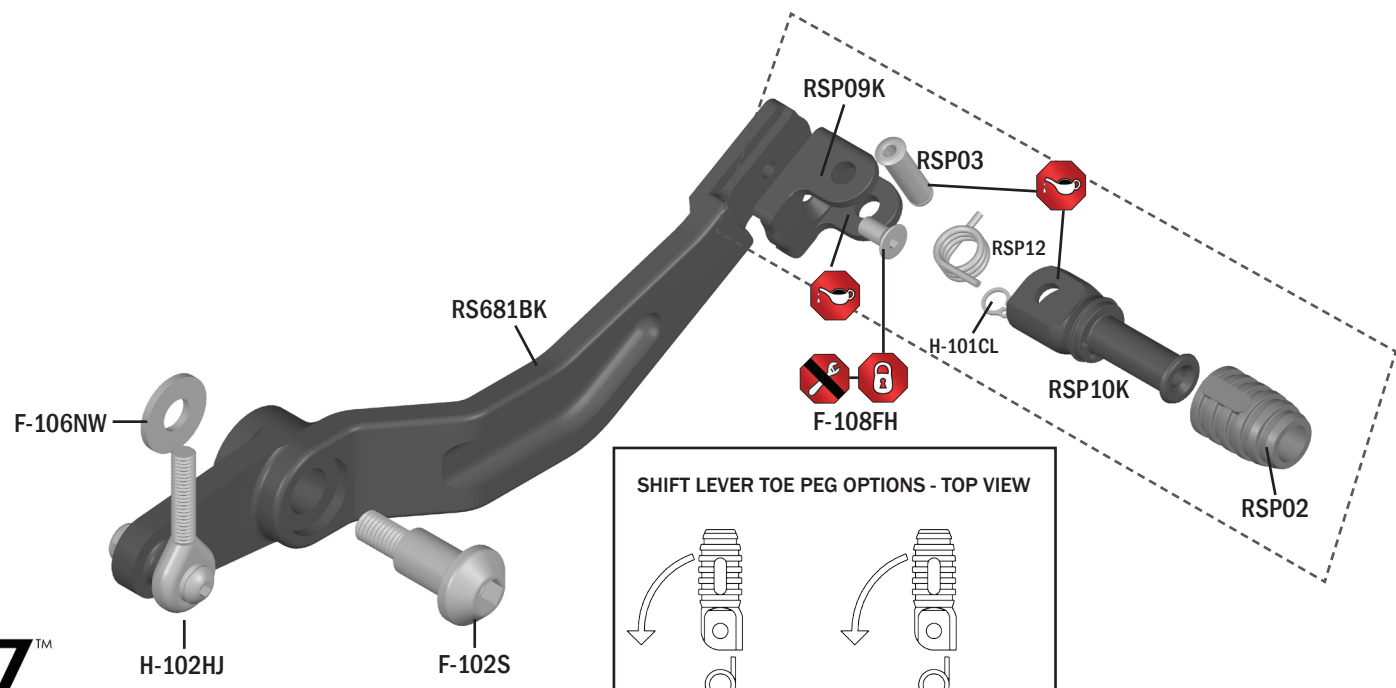
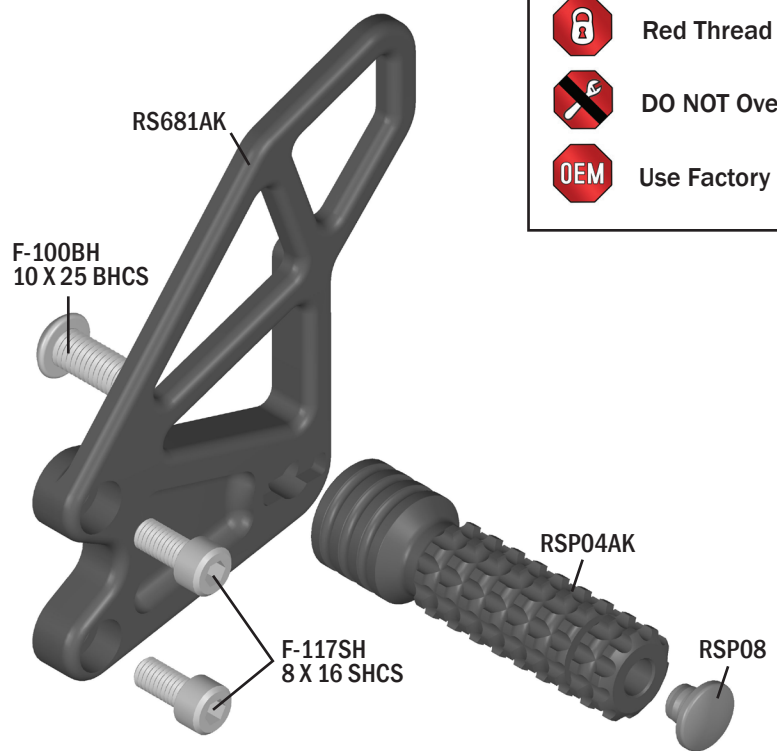
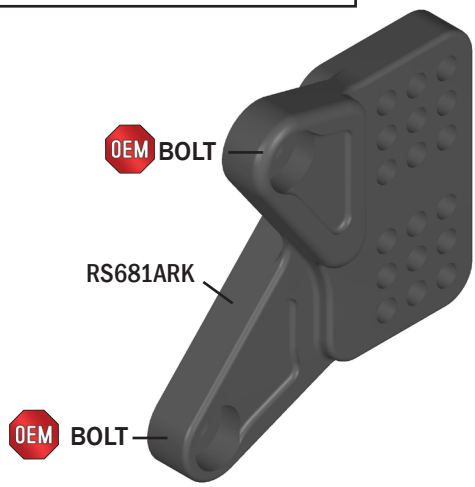

1.800.440.3559  
www.VORTEXRACING.com

