



**Ducati Hypermotard 796, 1100, 1100S (ALL)  
Ducati Monster 600, 620, 695, 750, 800, 1000  
(ALL) Ducati S2R (01-UP) S4RS/Tricolore (Water  
cooled only) Ducati Sport Classic Paul Smart,  
Sport 1000, GT1000 (06-UP) Ducati Multistrada**

**620, 1000, 1100DS (03-UP) Ducati Super Sport / Sport 620, 750, 800, 900, 1000  
NO CUT Frame Slider Installation Instructions  
Part Numbers: 750-8209**

---

**MADE IN THE USA!**

**Carefully read instructions in their entirety before the install**

Professional installation is recommended. Always use proper safety measures during the install of this product. Do not try to install this product without proper tools, recently calibrated torque wrench, correct torque specifications from **factory service manual**, safety goggles and gloves. The motorcycle must be in a fixed secure position before the install process begins. Safely support engine when removing the stock though engine stud. **Shogun is not responsible for any part of your motorcycle for any reason.** Precisely measure location of cut and if in doubt at any point please call us before the install process has begun. Some photos in this section are used for **illustration** examples only.

Replacement Parts List: Left Side Components (as if you were sitting on the bike)

QTY	Price each	Part Numbers	Descriptions
1	\$25.00	99-FS-750-8209-L	Black Left Side Puck
1	\$25.00	99-HR-TH121250401	Socket Cap 12 X 1.25 X 401 Main Engine Through Stud
1	\$0.50	99-HN-LN12125	12 x 1.25 Hex Flange Lock Nut
1	\$15.00	428-9103	Left/Right Side Bell Type Spacer

Replacement Parts List: Right Side Components (as if you were sitting on the bike)

1	\$25.00	99-FS-750-8209-R	Black Right Side Puck
1	\$0.50	99-HN-LN12125	12 x 1.25 Hex Flange Lock Nut
1	\$15.00	428-9103	Left/Right Side Bell Type Spacer

Frame Sliders: Left and Right hand frame sliders are the same

1. Make sure the vehicle is in a fixed secure position. With a standard floor jack, **support** the engine enough to remove main engine stud. To help prevent scratching or damage to the bike when lifting, we use a small piece of soft wood or a plastic puck on the jack pad.

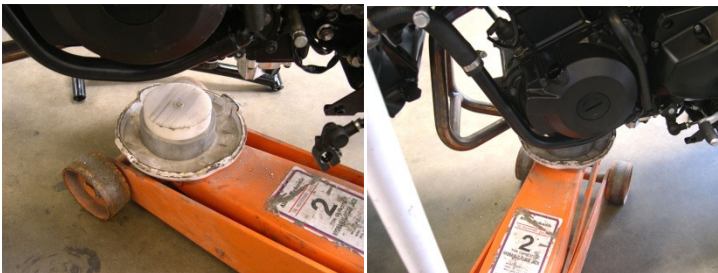

2. Remove the rubber caps to expose the main engine stud bolt and nut. Remove the nut and OEM Bolt.

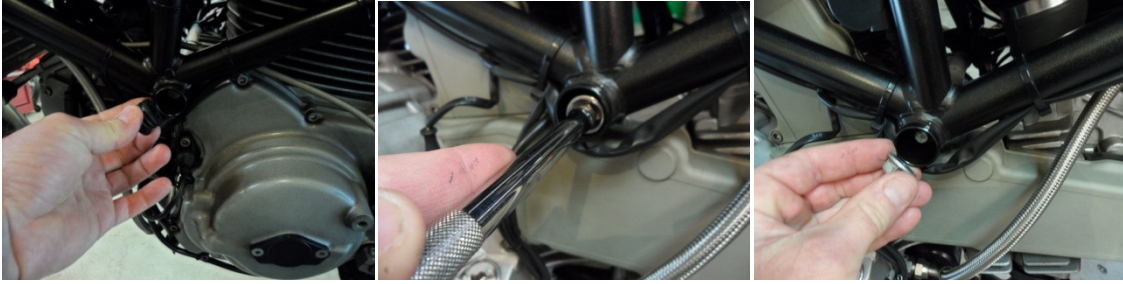

3. Slide the right hand slider (99-FS-750-8209-R) and spacer (428-9103) over the supplied engine stud as shown below and install engine stud through frame.



4. Install spacer (428-9103) and left hand slider (99-FS-750-8209-L) with provided nut (99-HN-LN12125). Torque nut down to the OEM torque specifications.



#### READ CAREFULLY

Shogun cannot guarantee that they will protect your motorcycle from any extent of damage. Shogun frame sliders are really meant to help possibly save the frame from damage in the event of a crash. Because Shogun frame slider products have been successful in saving cases, bodywork, levers and so on in the past, customers just assume sometimes you can put the product on and no damage will happen. The fact is, some crashes result in little or no damage to the motorcycle and some bikes are destroyed. It's kind of like a bumper on a car sometimes it works sometimes it doesn't, it really depends on all the different forces applied during the incident. We've seen bikes crash at 100 mph with little damage and some at 15 mph with major damage.